

182360 - 00



Demeyere  
GROUP

- (FR)** NOTICE DE MONTAGE
- (EN)** ASSEMBLY INSTRUCTIONS
- (DE)** MONTAGEANLEITUNG
- (ES)** INSTRUCCIONES DE MONTAJE
- (NL)** MONTAGEVOORSCHRIFT
- (IT)** ISTRUZIONI DI MONTAGGIO
- (PT)** INSTRUÇÕES DE MONTAGEM
- (CR)** NAPUTCI ZA MONTAŽU
- (HU)** ÖSSZESZERELÉSI UTASÍTÁSOK

تعليمات التركيب (ع)

 **Max**  
**1 Kg / 3 Lbs**

 **Max**  
**28 Kg / 61 Lbs**

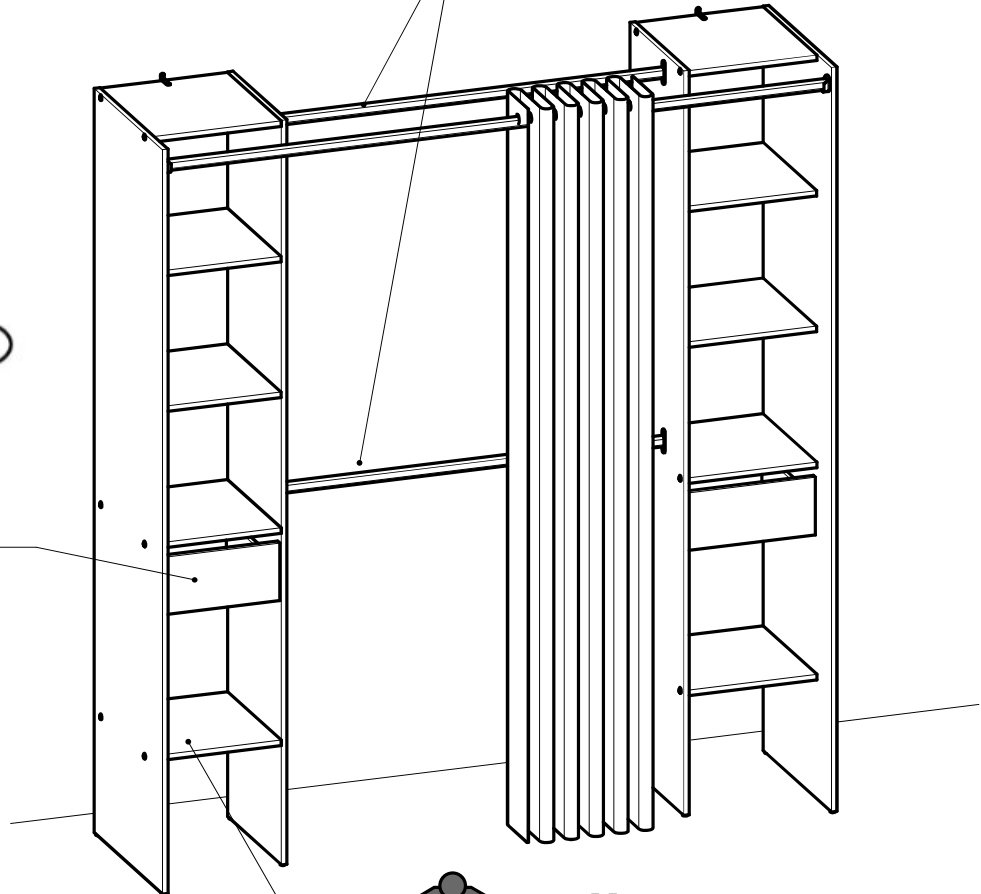

 **Max**  
**5 Kg / 12 Lbs**

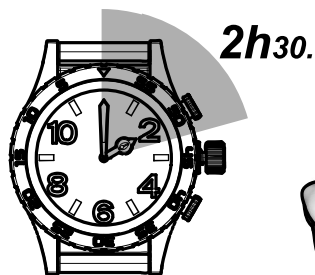

159947

 **Fabriqu  en France**  
**Made in France**

**S.A. Meubles DEMEYERE - 178-184 rue de la Pr v t **  
**59840 P renchies - FRANCE**

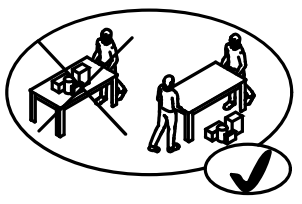
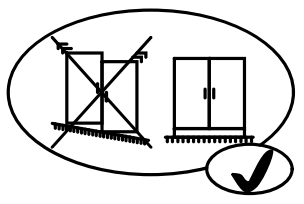
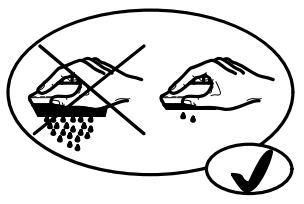
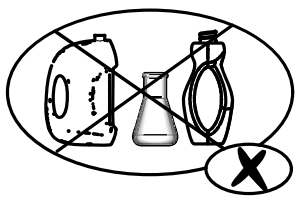
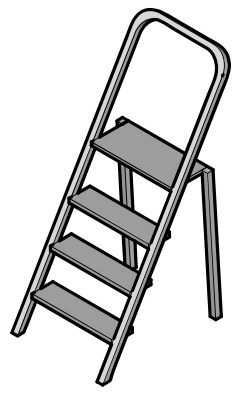
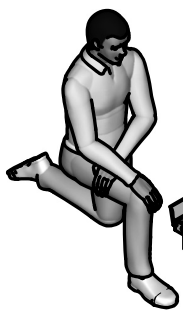
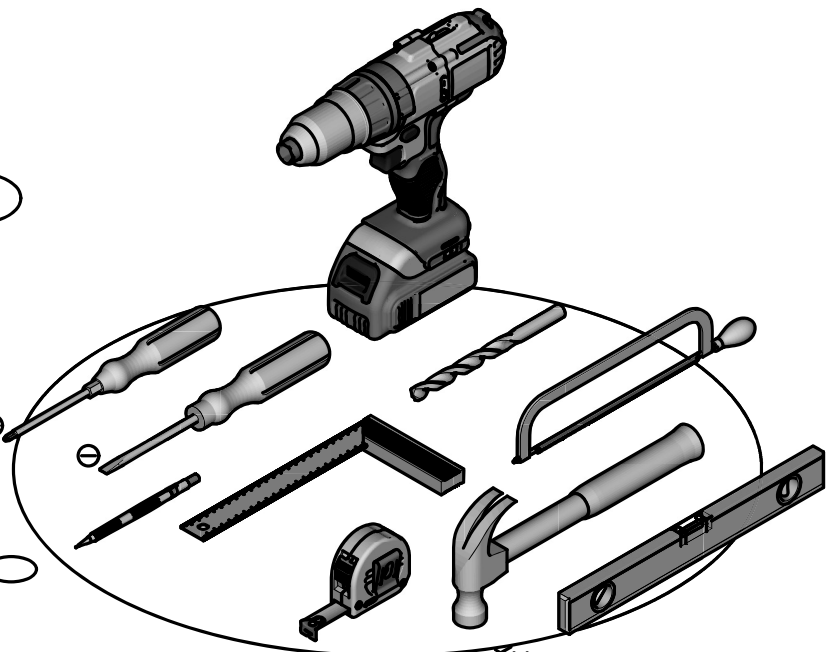
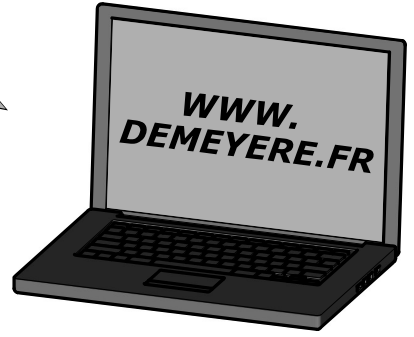
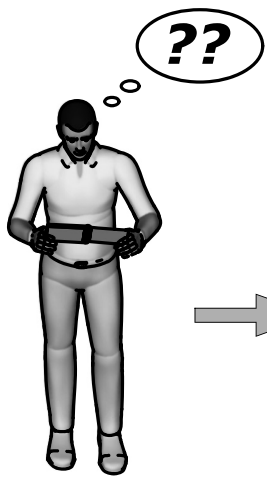



**B** x1

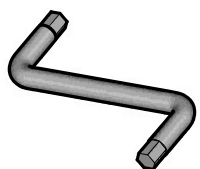

**C** x2

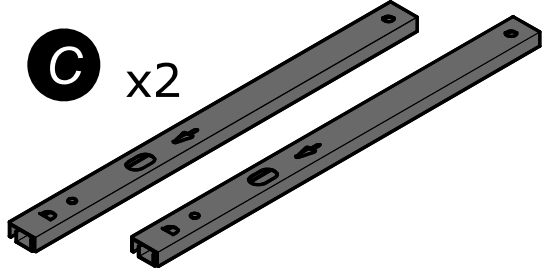

**D** x4

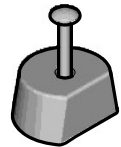

**E** x16



**F** x8

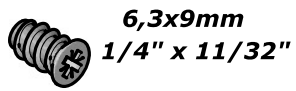

**G** x2

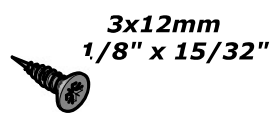

**H** x10

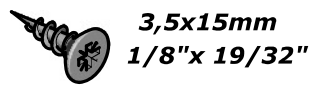

**I** x4

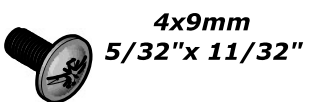

**J** x24



**N** x4

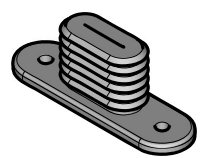

**O** x1

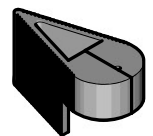

**Q** x2

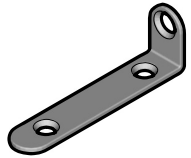

**R** x8

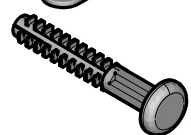

**S** x24



**T** x4

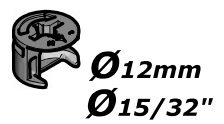

**U** x2

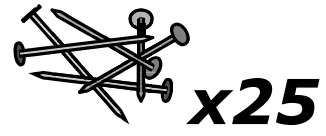

**V** x4



**W** x1

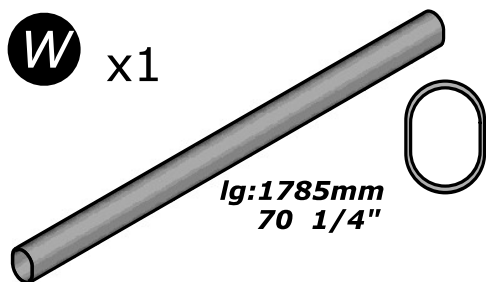

**X** x2

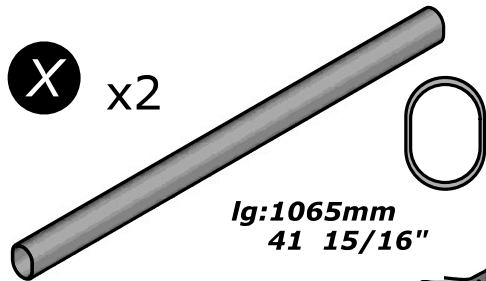

**Y** x1

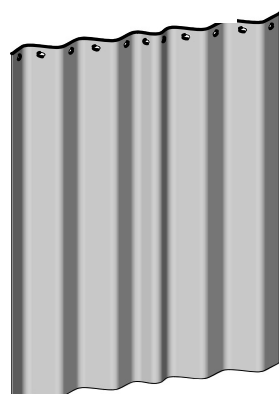

**Z** x2

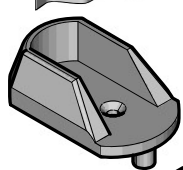

**AA** x3

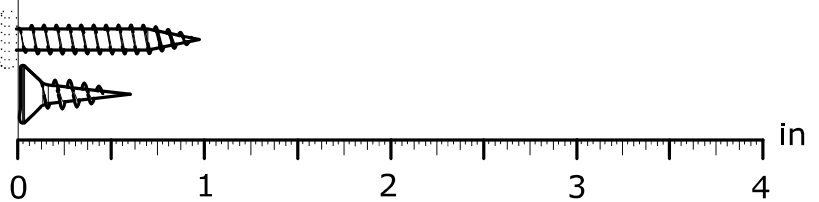
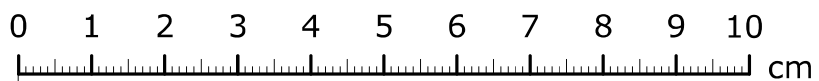
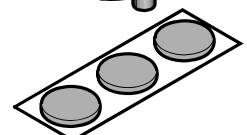

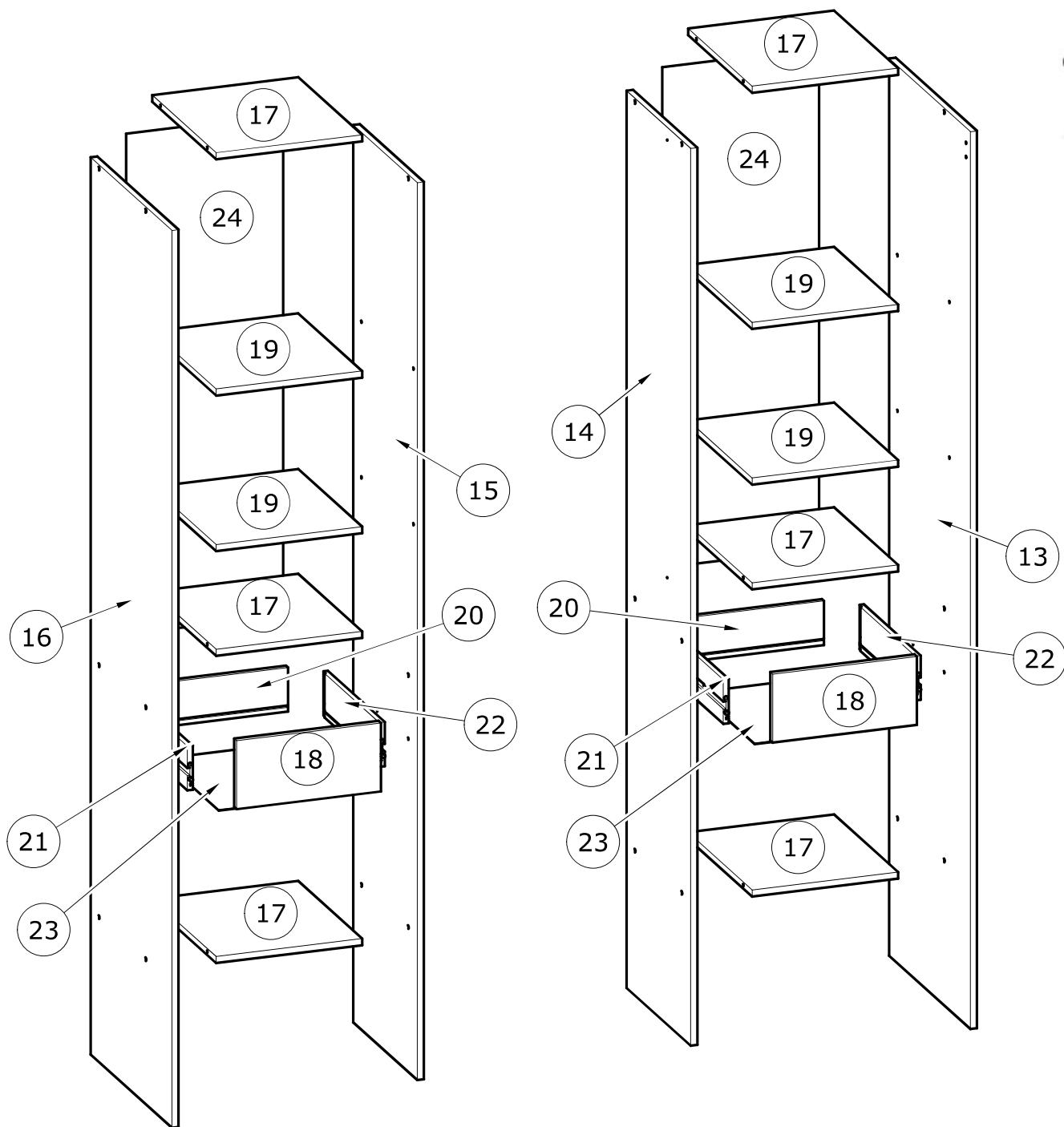

N°	MM		INCH		QTY
13	2 000	x 499	78 12/16	x 19 10/16	1
14	2 000	x 394	78 12/16	x 15 8/16	1
15	2 000	x 394	78 12/16	x 15 8/16	1
16	2 000	x 499	78 12/16	x 19 10/16	1
17	345	x 393	13 9/16	x 15 8/16	6
18	341	x 155	13 7/16	x 6 2/16	2
19	345	x 391	13 9/16	x 15 6/16	4
20	317	x 100	12 8/16	x 3 15/16	2
21	350	x 100	13 12/16	x 3 15/16	2
22	350	x 100	13 12/16	x 3 15/16	2
23	323	x 348	12 11/16	x 13 11/16	2
24	1 102	x 369	43 6/16	x 14 8/16	2

FR

**AVERTISSEMENT : MEUBLE A FIXER IMPERATIVEMENT AU MUR AFIN D'EVITER SON BASCULEMENT**

- Pour installer correctement ce produit et éliminer les risques pour votre sécurité, merci de suivre exactement ce manuel d'instruction.
- Fixer le meuble au mur avec les attaches prévues à cet effet
- Les vis et les chevilles ne sont pas fournies. Utiliser des vis et des chevilles adaptées au support.

EN

**WARNING: FURNITURE TO BE ATTACHED TO THE WALL TO PREVENT OVERTURNING**

- Installation shall be carried out exactly according to those instructions-otherwise a safety risk can occur if incorrectly installed;
- Attach the furniture to the wall with the fastening provided for this purpose
- Screw and Pegs are not supplied. Use Screws and pegs adapted to the support.

DE

**WARNUNG: DAS MÖBEL MUSS AN DER WAND BEFESTIGT WERDEN, UM ZU VERHINDEN DASS ES KIPPT**

- Um das Produkt korrekt zu installieren und um Risiken für Ihre Sicherheit zu verhindern, die Gebrauchsanleitung genauestens befolgen.
- Das Möbel mit den vorgesehenen Befestigungen an einer Wand befestigen.
- Schrauben und Dübel sind nicht im Lieferumfang enthalten. Passende Schrauben und Dübel verwenden.

ES

**ADVERTENCIA: ESTE MUEBLE DEBE ESTAR SIEMPRE FIJO EN LA PARED PARA EVITAR QUE VUELQUE**

- Para instalar correctamente este producto y eliminar los riesgos para la seguridad, seguir exactamente las instrucciones del manual.
- Fijar el mueble a la pared con las sujeciones previstas a este efecto.
- Los tornillos y los tacos no están incluidos. Utilizar tornillos y tacos adaptados al soporte.

NL

**WAARSCHUWING: MEUBEL MOET VERPLICHT AAN DE MUUR BEVESTIGD WORDEN ZODAT HET NIET KAN OMVALLEN**

- Om dit product correct te installeren en alle risico's voor uw veiligheid te elimineren, gelieve de instructies in deze handleiding nauwgezet op te volgen.
- Zet het meubel vast aan de muur met de hiertoe voorziene bevestigingen.
- De schroeven en pluggen zijn niet meegeleverd. Gebruik schroeven en pluggen die geschikt zijn voor het materiaal van de muur.

IT

**AVVERTENZA: MOBILE DA FISSARE IMPERATIVAMENTE AL MURO PER EVITARE CHE SI RIBALTI**

- Per installare correttamente questo prodotto ed eliminare i rischi per la vostra sicurezza, si prega di seguire esattamente il manuale d'istruzioni.
- Fissare il mobile al muro con gli appositi ganci.
- Le viti e i tasselli non sono forniti. Utilizzare viti e tasselli adatti al supporto.

PT

**ADVERTÊNCIA: MÓVEL A FIXAR OBRIGATORIAMENTE À PAREDE PARA EVITAR A SUA QUEDA**

- Para instalar corretamente este produto e eliminar os riscos para a sua segurança, é favor seguir exatamente este manual de instruções.
- Fixe o móvel à parede com as fixações previstas para o efeito
- Os parafusos e as cavilhas não são fornecidos. Utilize parafusos e cavilhas adaptados ao suporte.

CR

**UPOZORENJE : UČVRSTITE ORMARIĆ NA ZID KAKO BISTE SPRIJEČILI NJEGOVO LJULJANJE**

- Kako biste pravilno postavili ovaj proizvod i uklonili sigurnosne rizike kojima se izlažete, pridržavajte se strogo ovog priručnika s uputama.
- Postavite ormarić na zid pripadajućim sponama.Vijci i svornjci ne isporučuju se. Upotrijebite nosne vijke i svornjke.

Hu

**FIGYELEM: A BÚTORT FELTÉTENÜL RÖGZÍTENI KELL A FALHOZ, HOGY ELKERÜLJE A FELBILLENÉSÉT**

- A termék megfelelő elhelyezéséhez és a biztonságot érintő kockázatok kiküszöböléséhez pontosan kövesse ezt a használati útmutatót.
- Rögzítse a bútort a falhoz az erre a célra szolgáló rögzítőelemekkel.
- A csavarok és a tiplik nincsenek mellékelve. Használjon a tartóhoz illő csavarokat és tipliket.

العربية:

**تحذير: قطعة أثاث يلزم تثبيتها على الحائط لتجنب تأرجحها**

- لتركيب هذا المنتج بشكل صحيح وتجنب المخاطر من أجل سلامتك، يرجى اتباع كتيب التعليمات هذا بالضبط.
- تثبت قطعة الأثاث على الحائط بواسطة العلاقات المخصصة لهذا الغرض
- إن البراغي والخوابير غير متوفرة مع المنتج. تستخدم براغي وخوابير ملائمة للحائط الذي يتم التثبيت عليه.

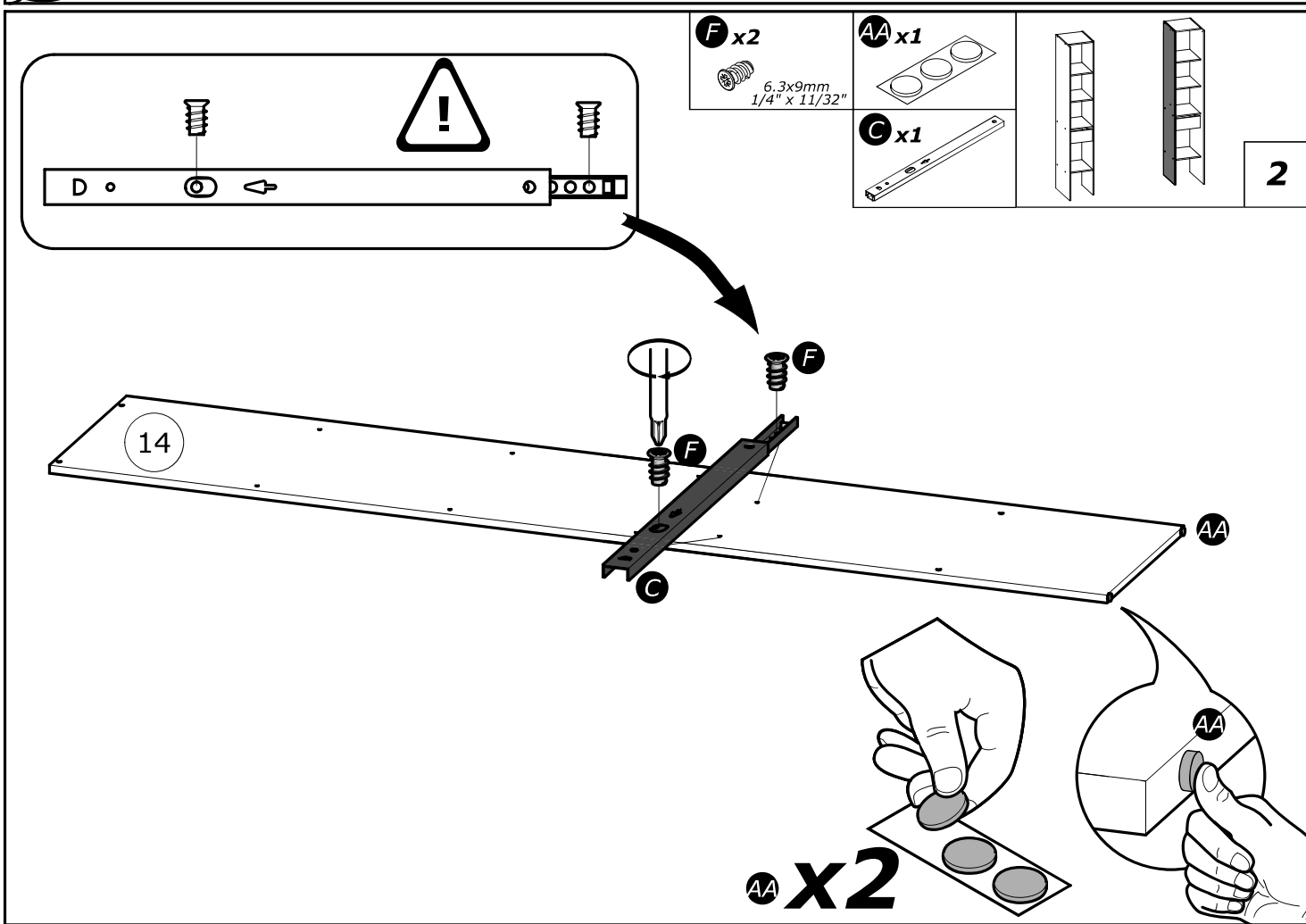
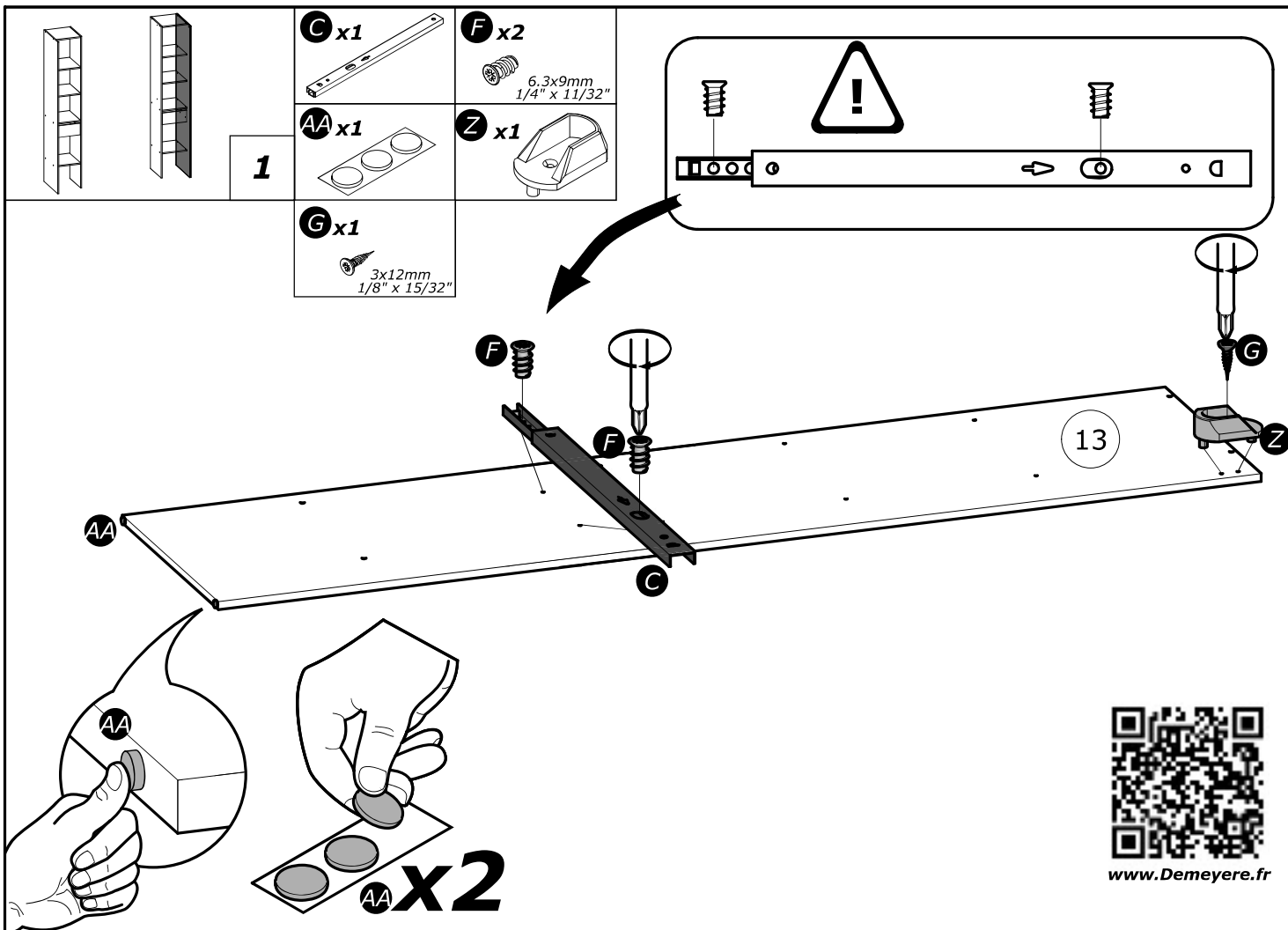

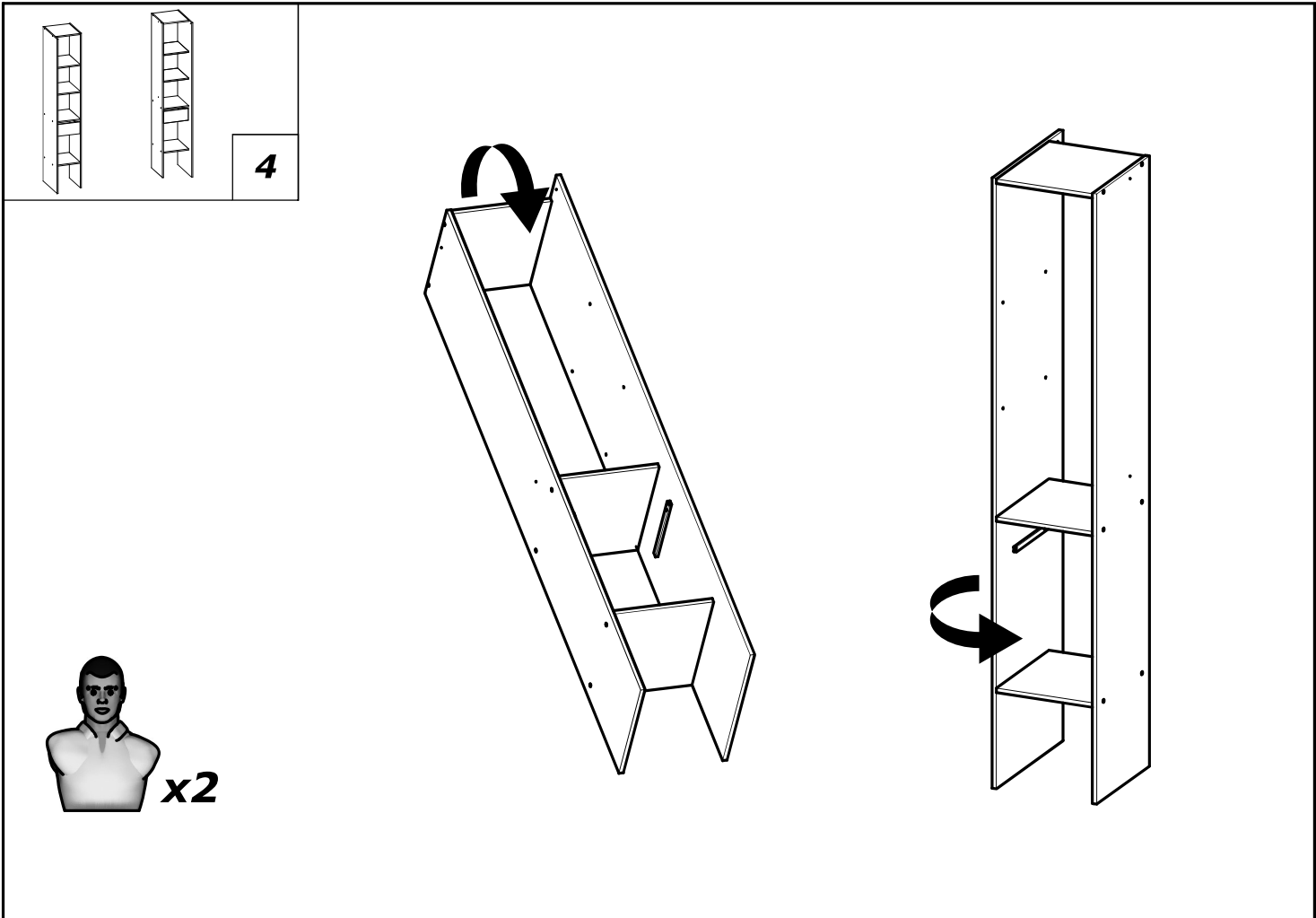
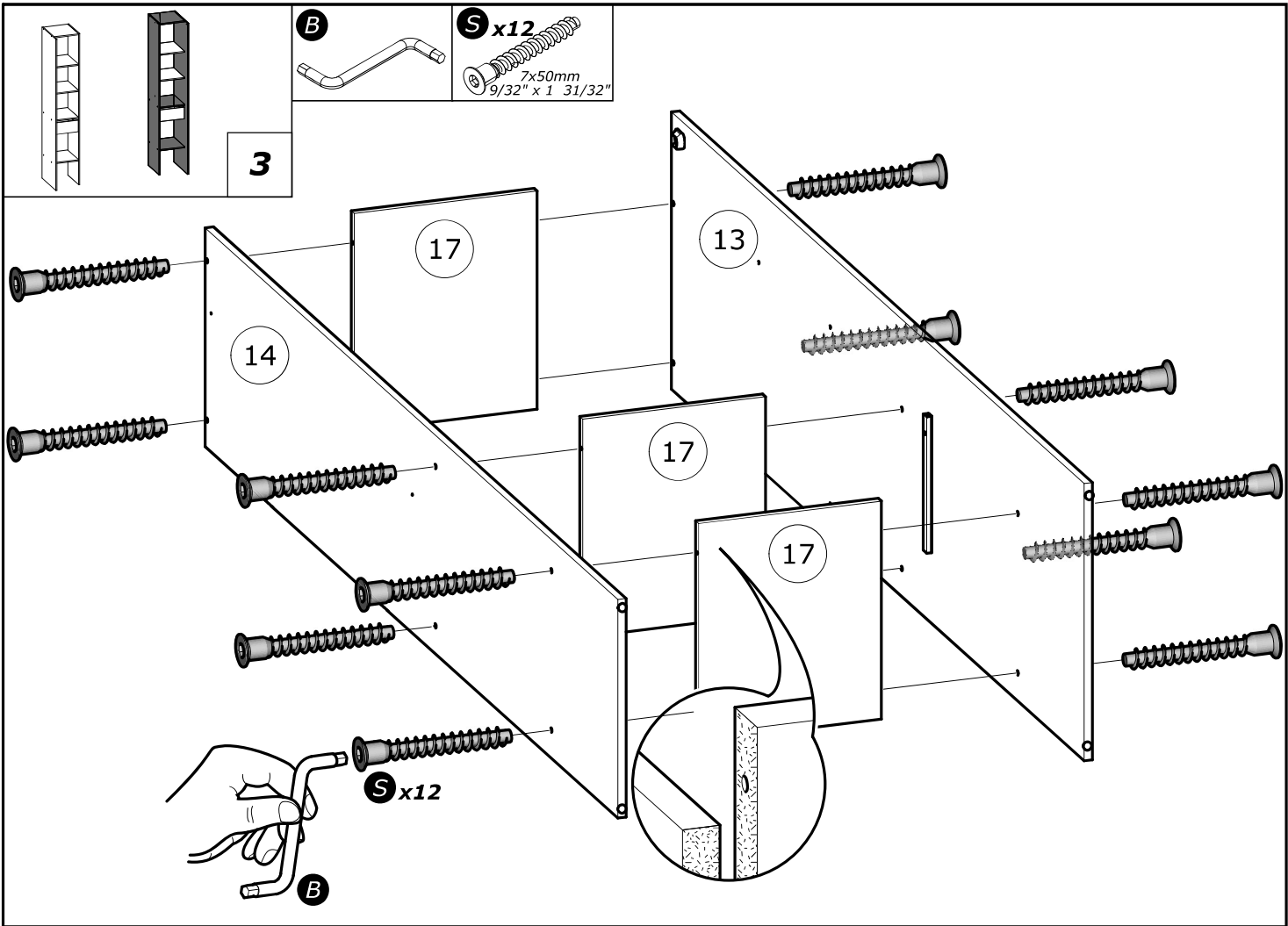

U x18



O

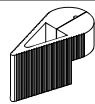

5

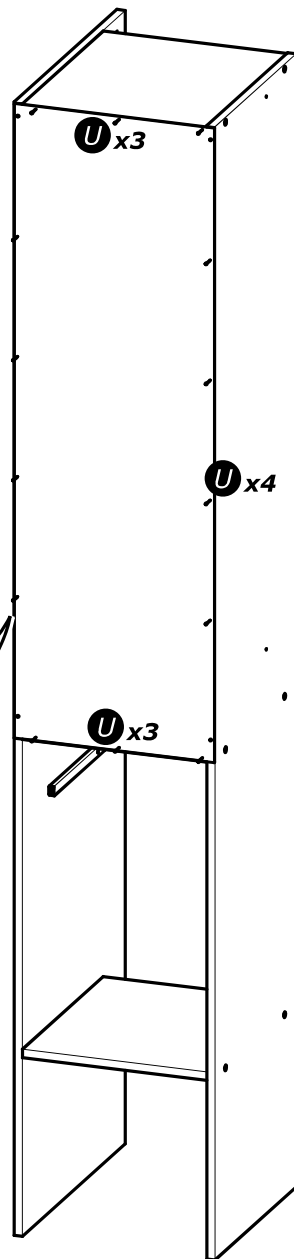
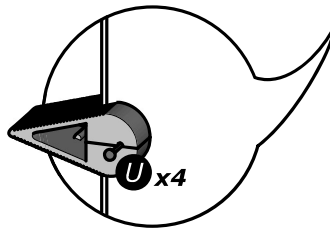
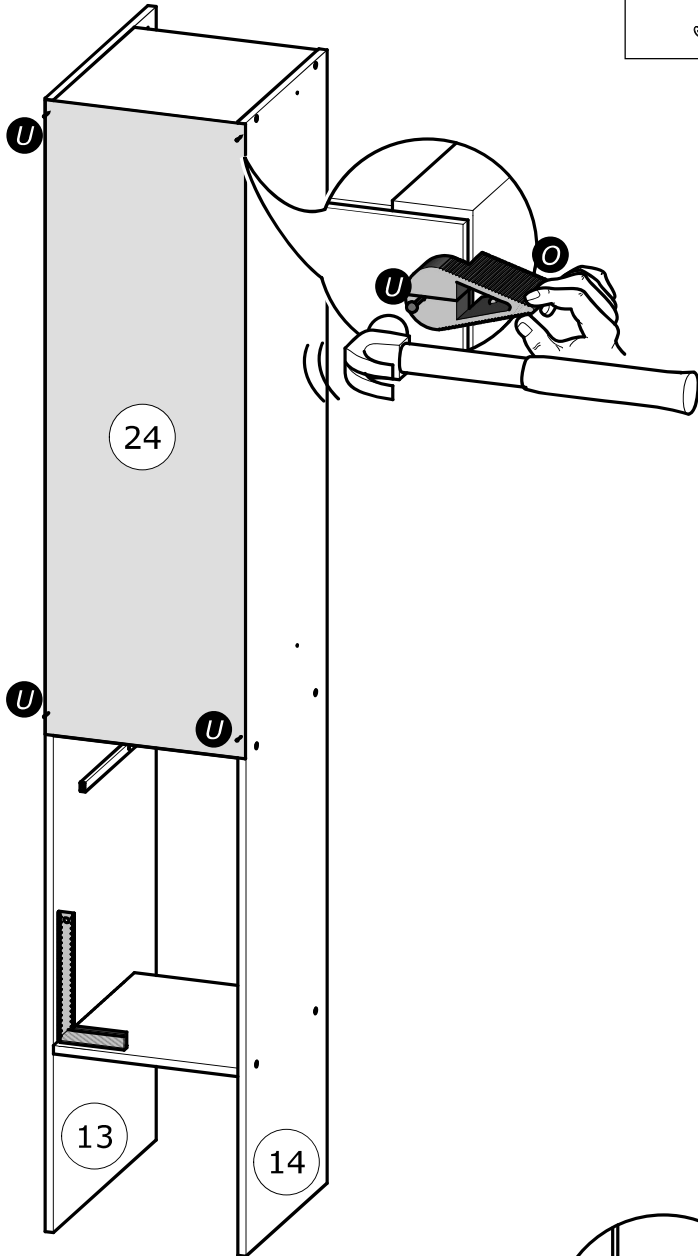

www.Demeyere.fr

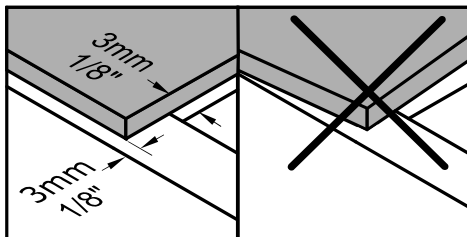

x2



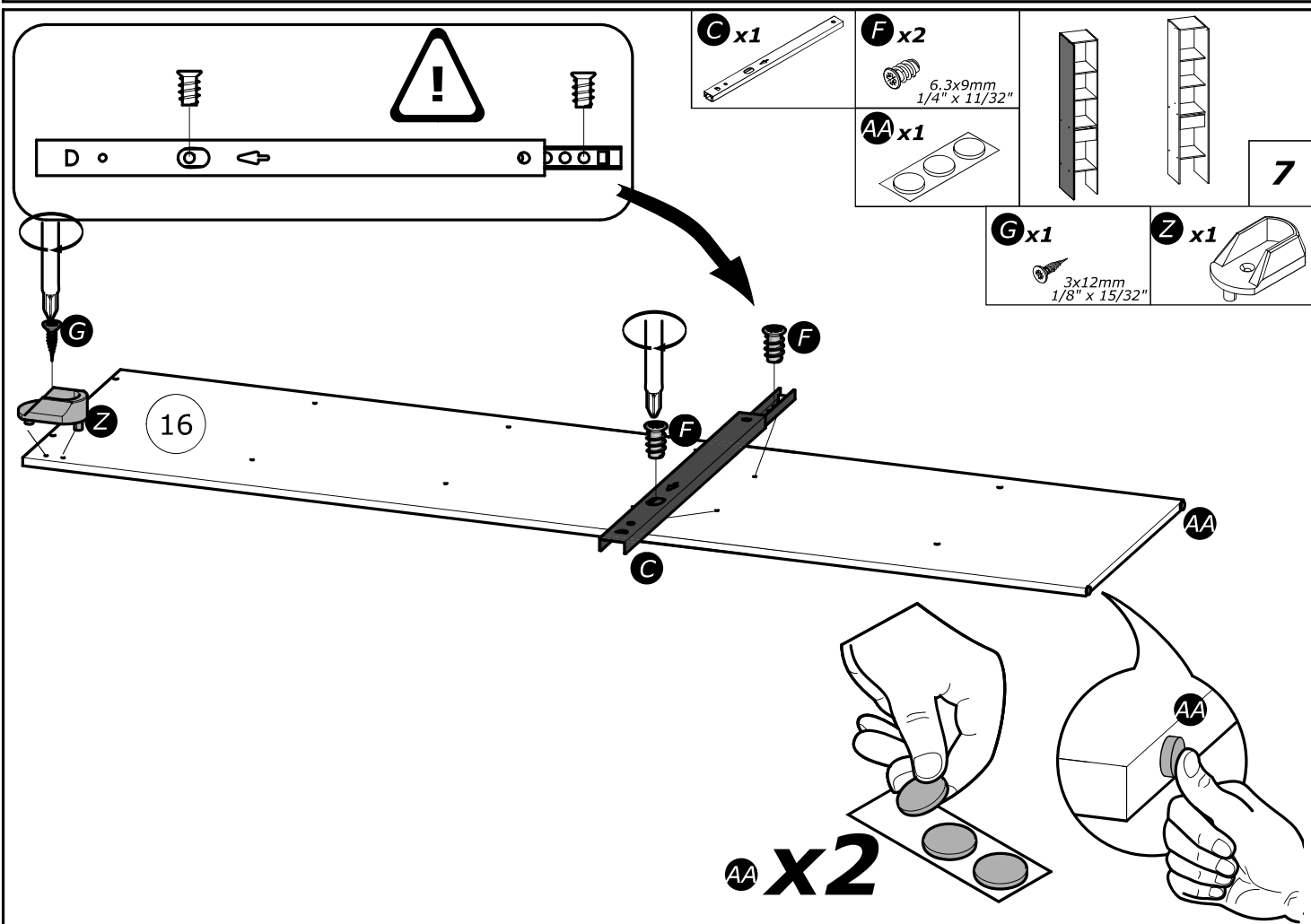
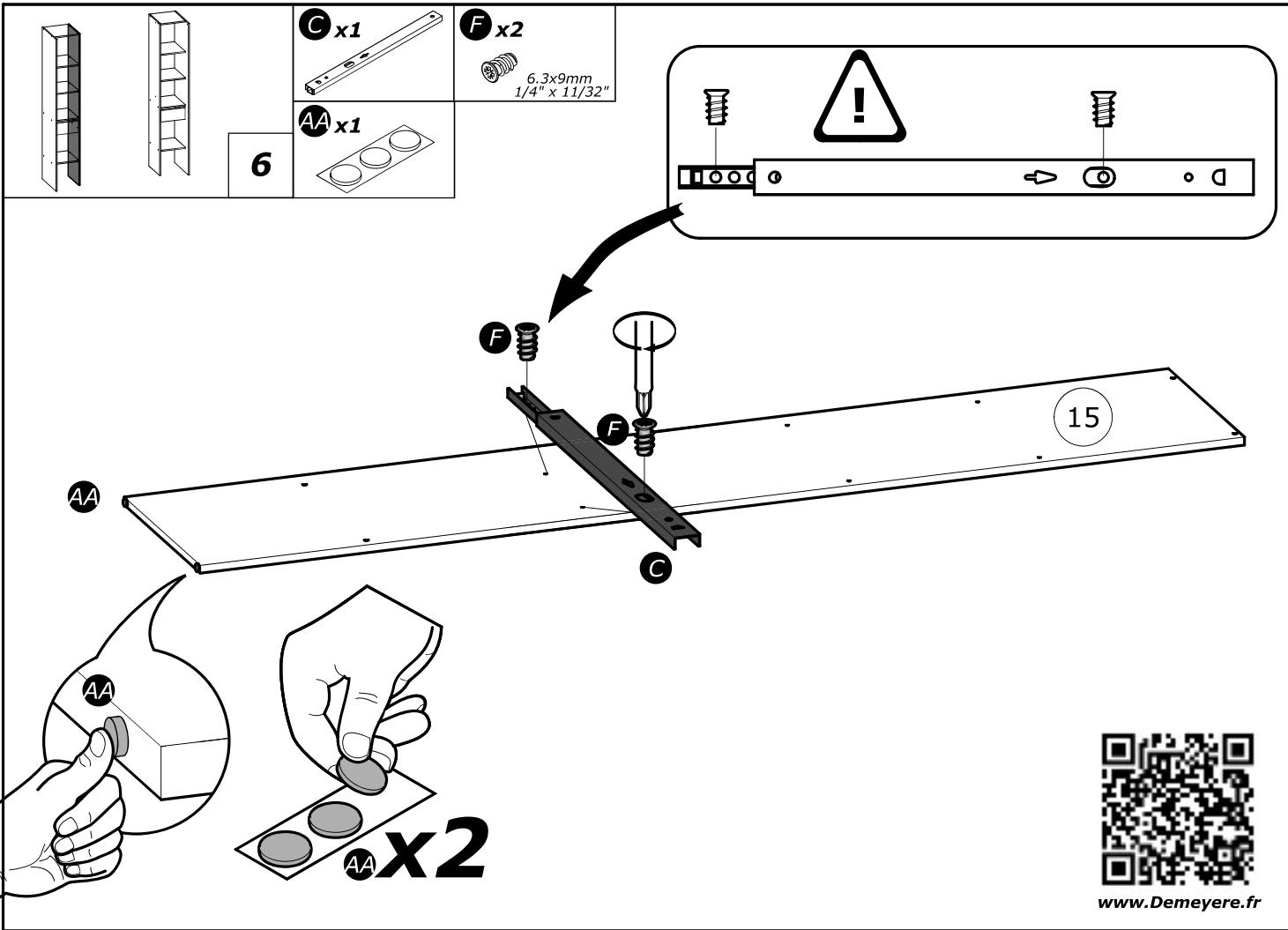

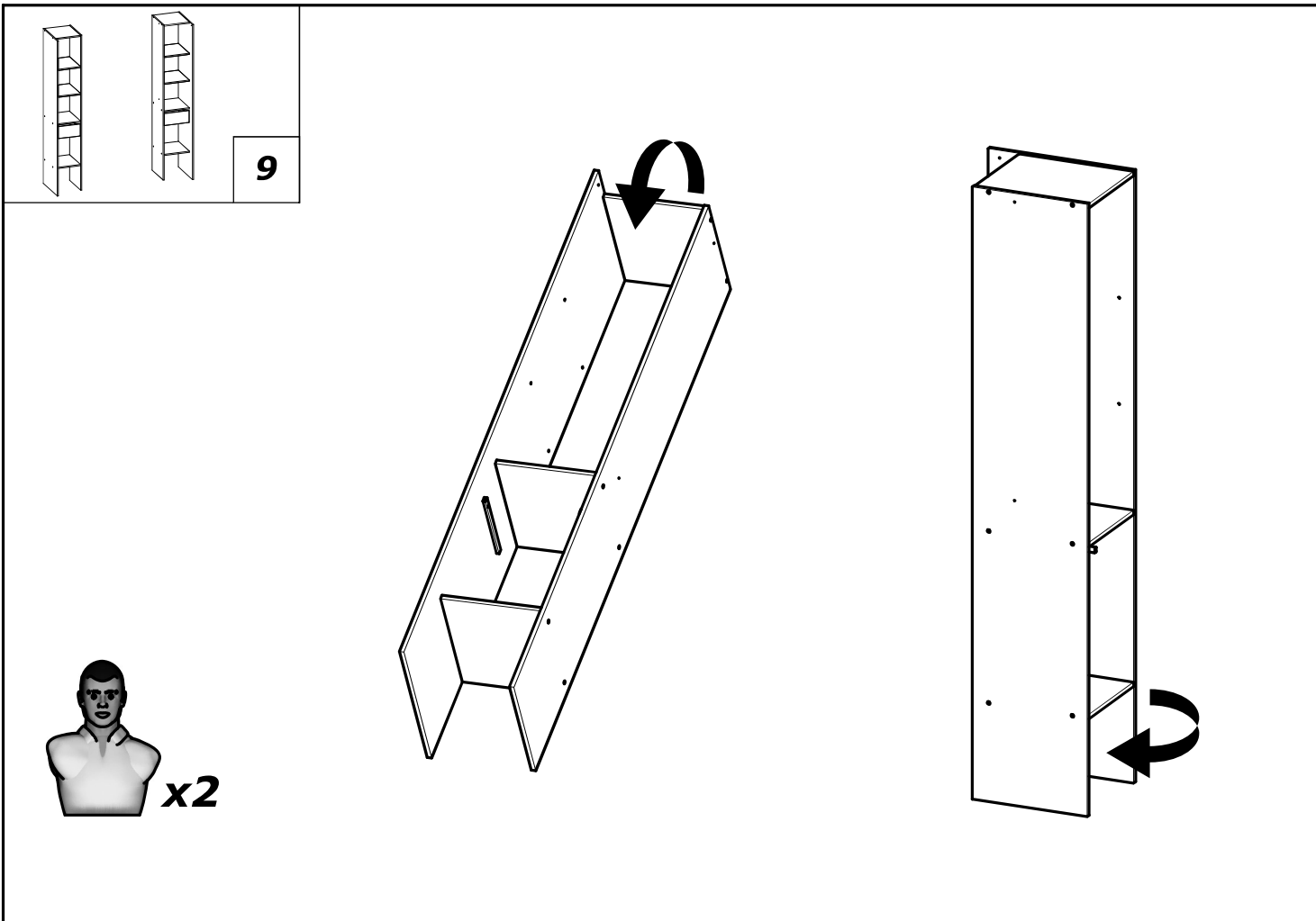
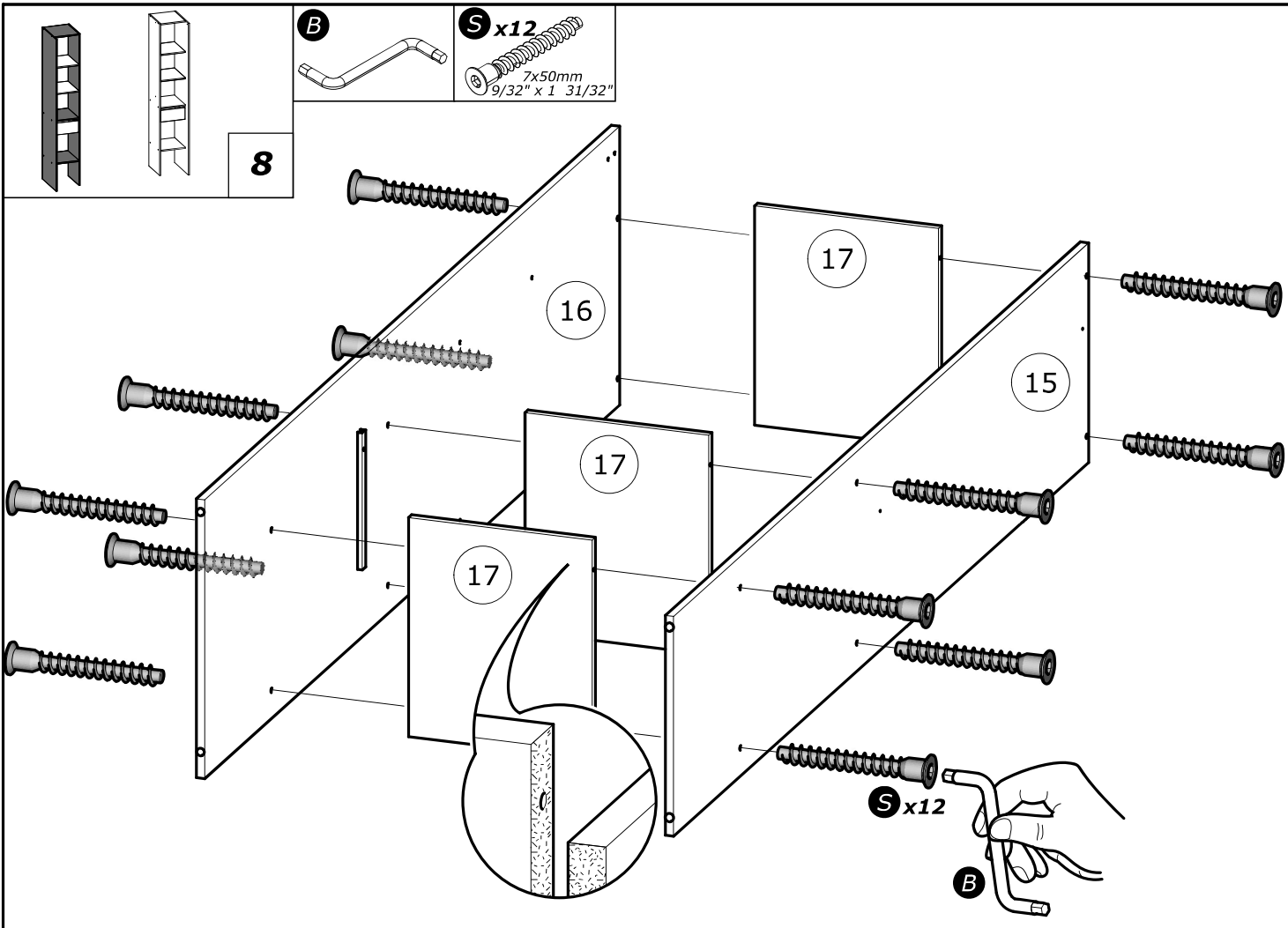

U x18



O

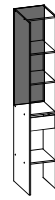
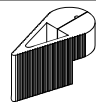

10

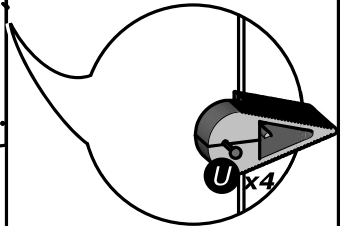
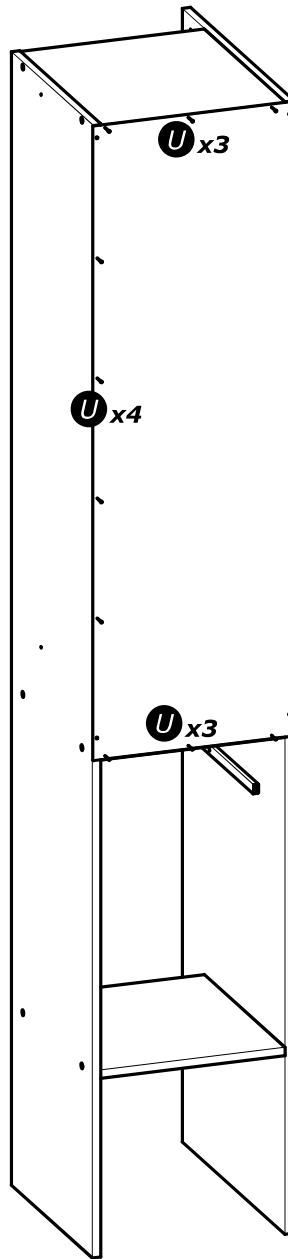
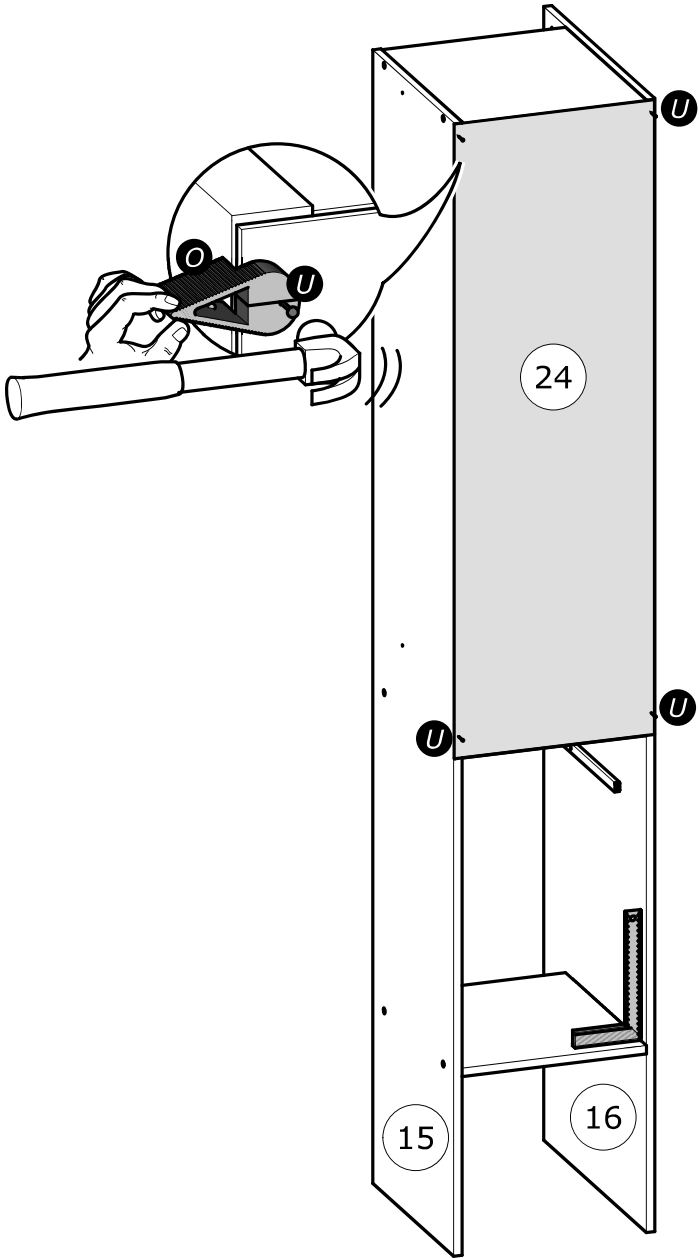

www.Demeyere.fr

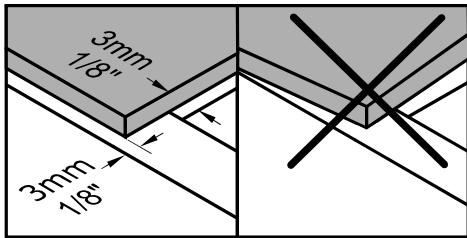

x2

**A**

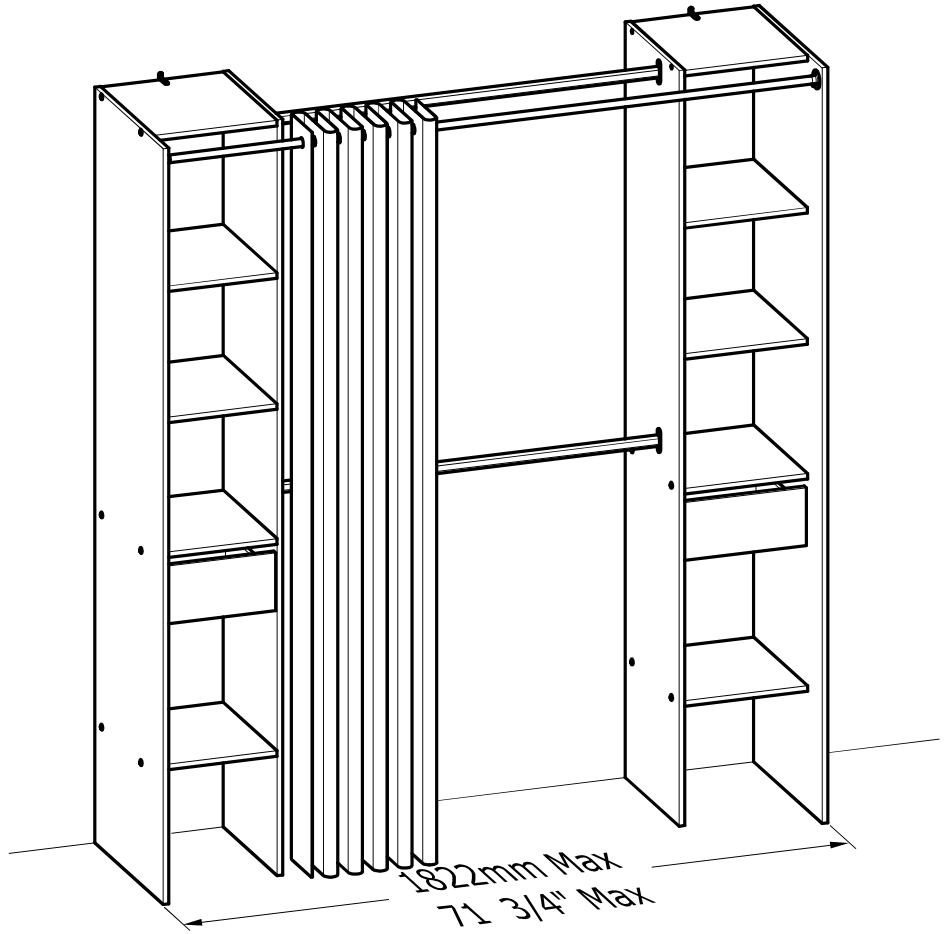

**B**

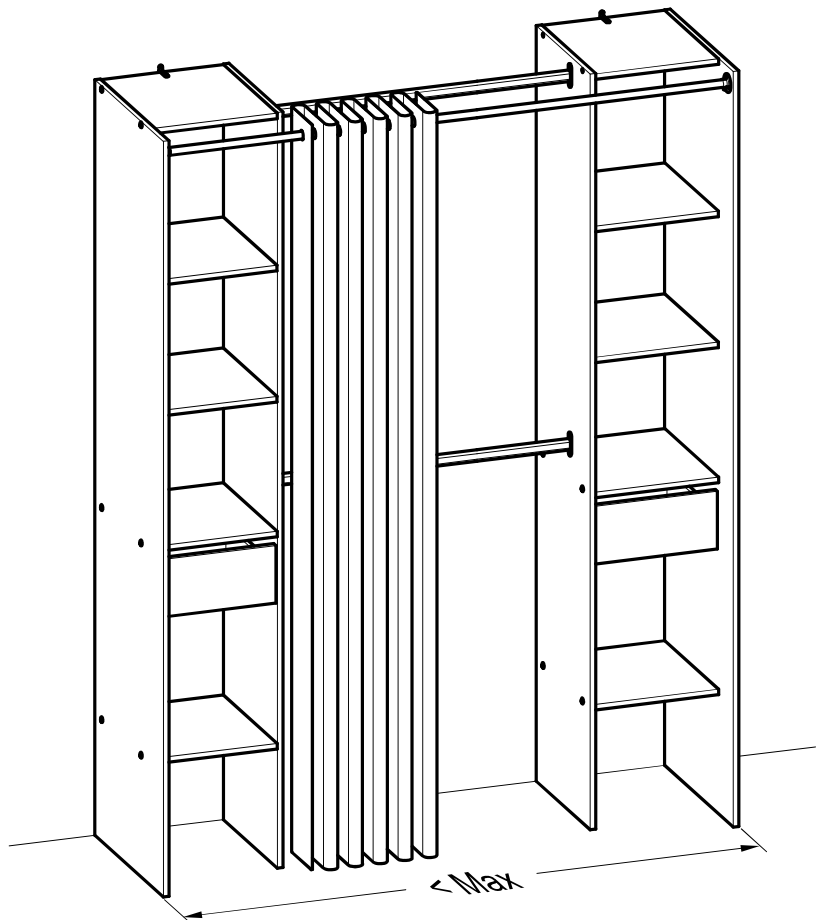
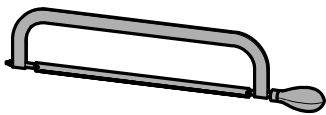

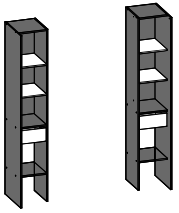

**11**  
**A&B**

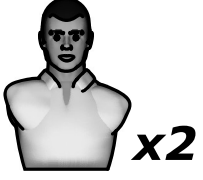
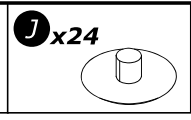
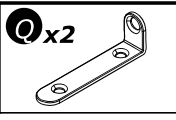
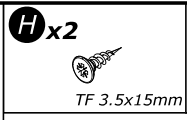

**x2**

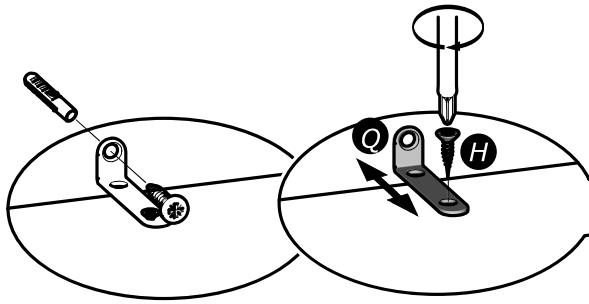

180 mm  
7 1/16

**X1**

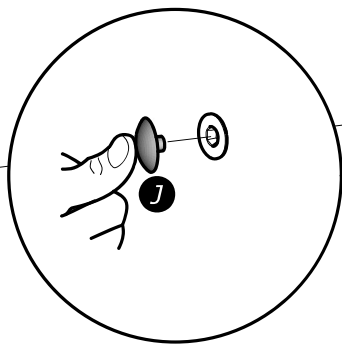
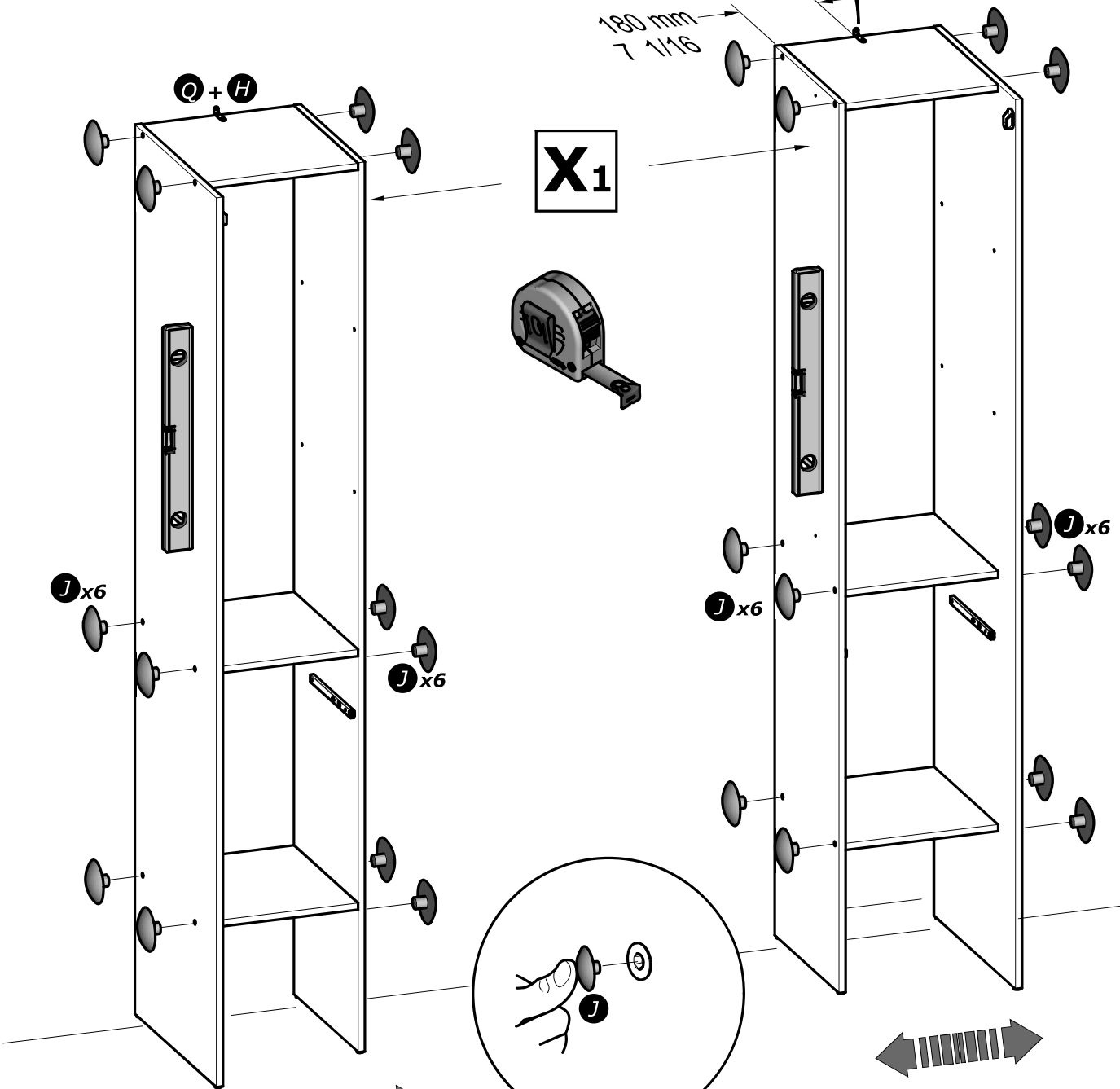
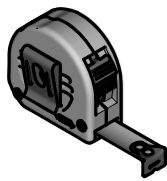

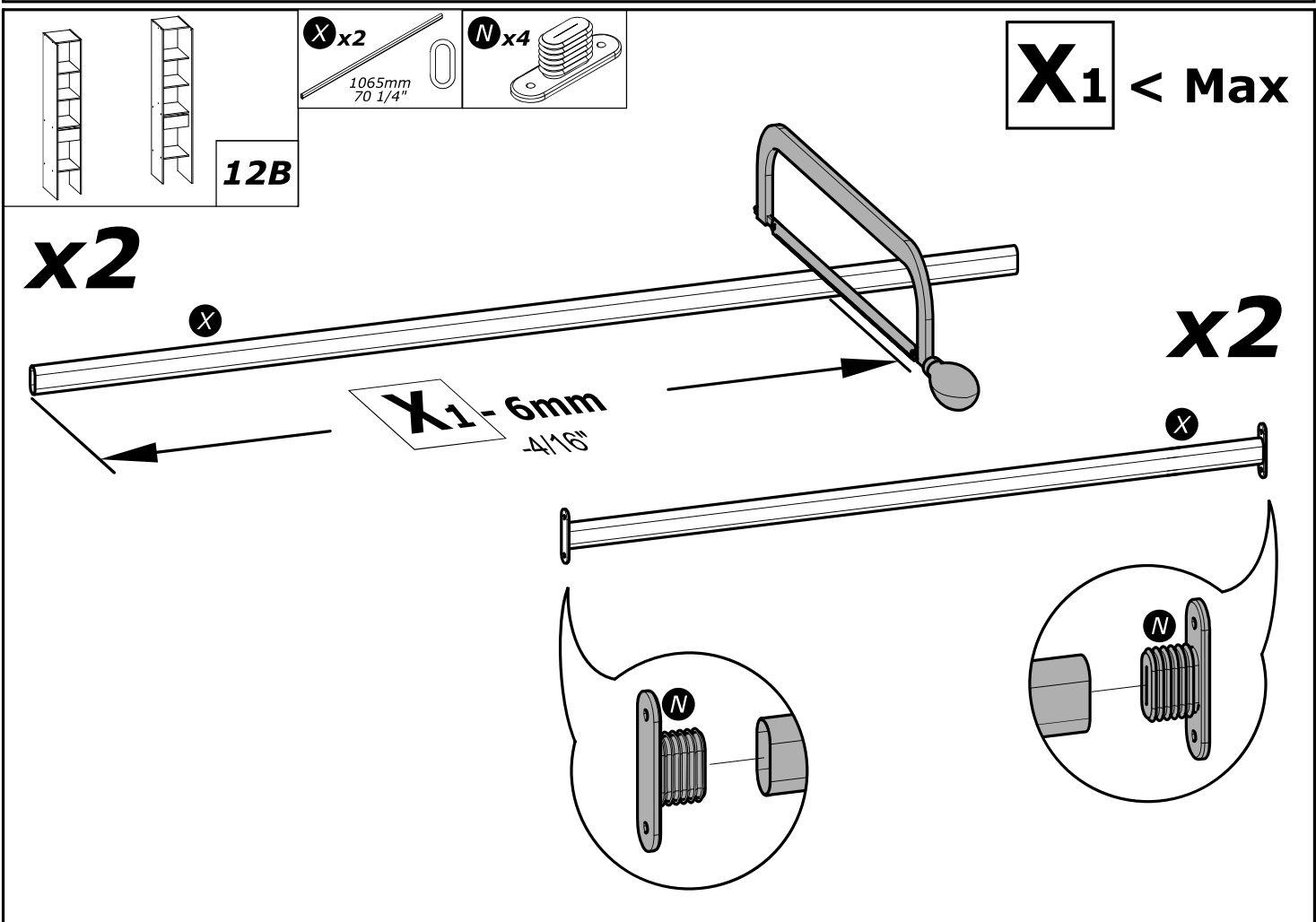
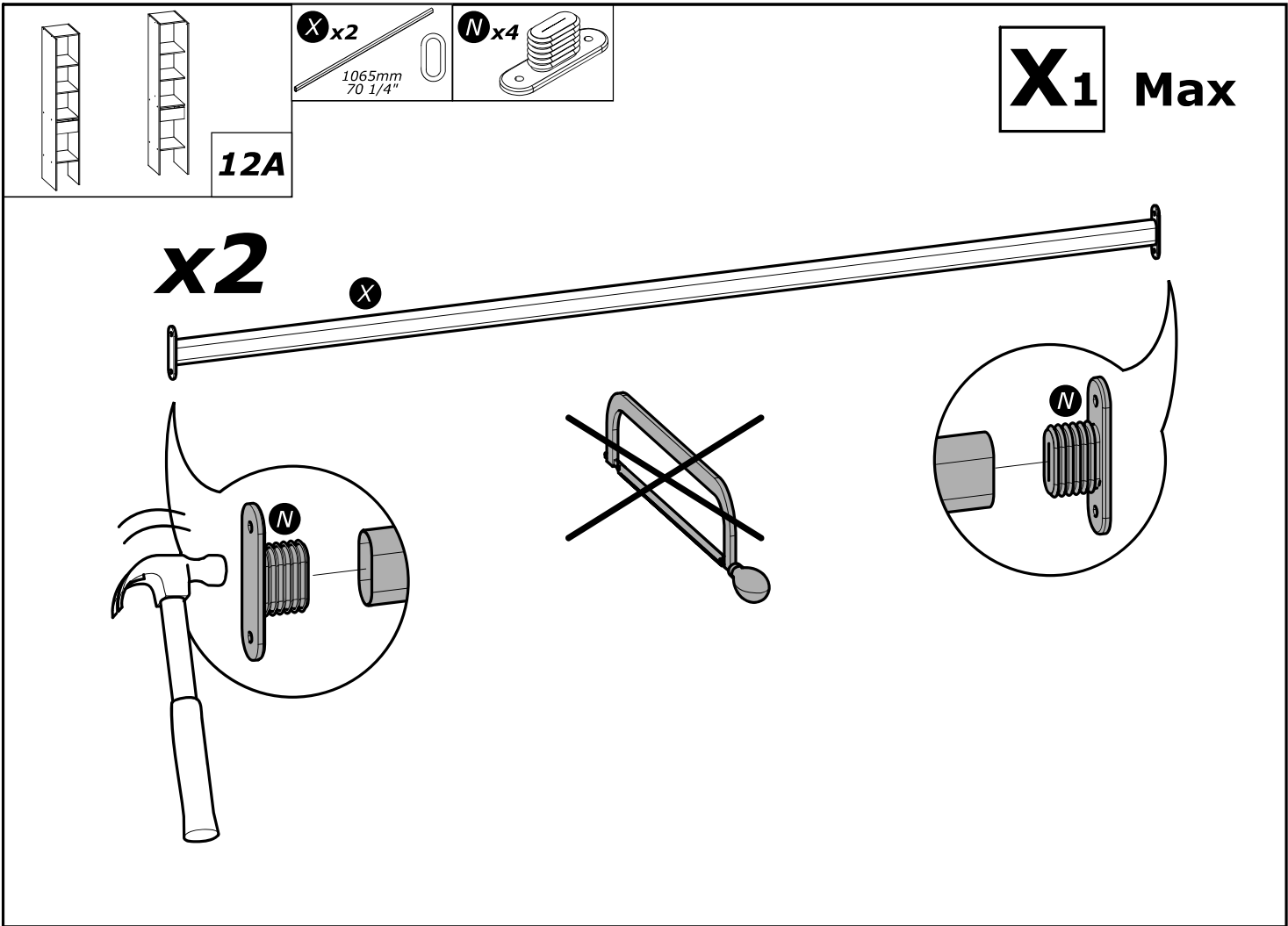

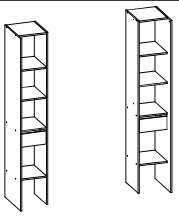

**13**  
**A&B**

**H** x8  
3.5x15mm  
1/8" x 19/32"

**x2**

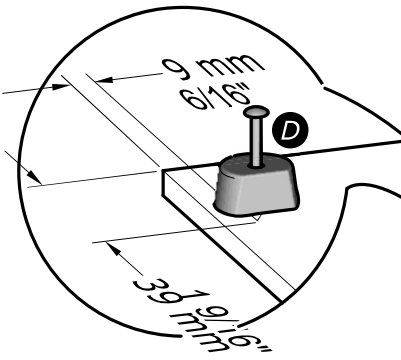
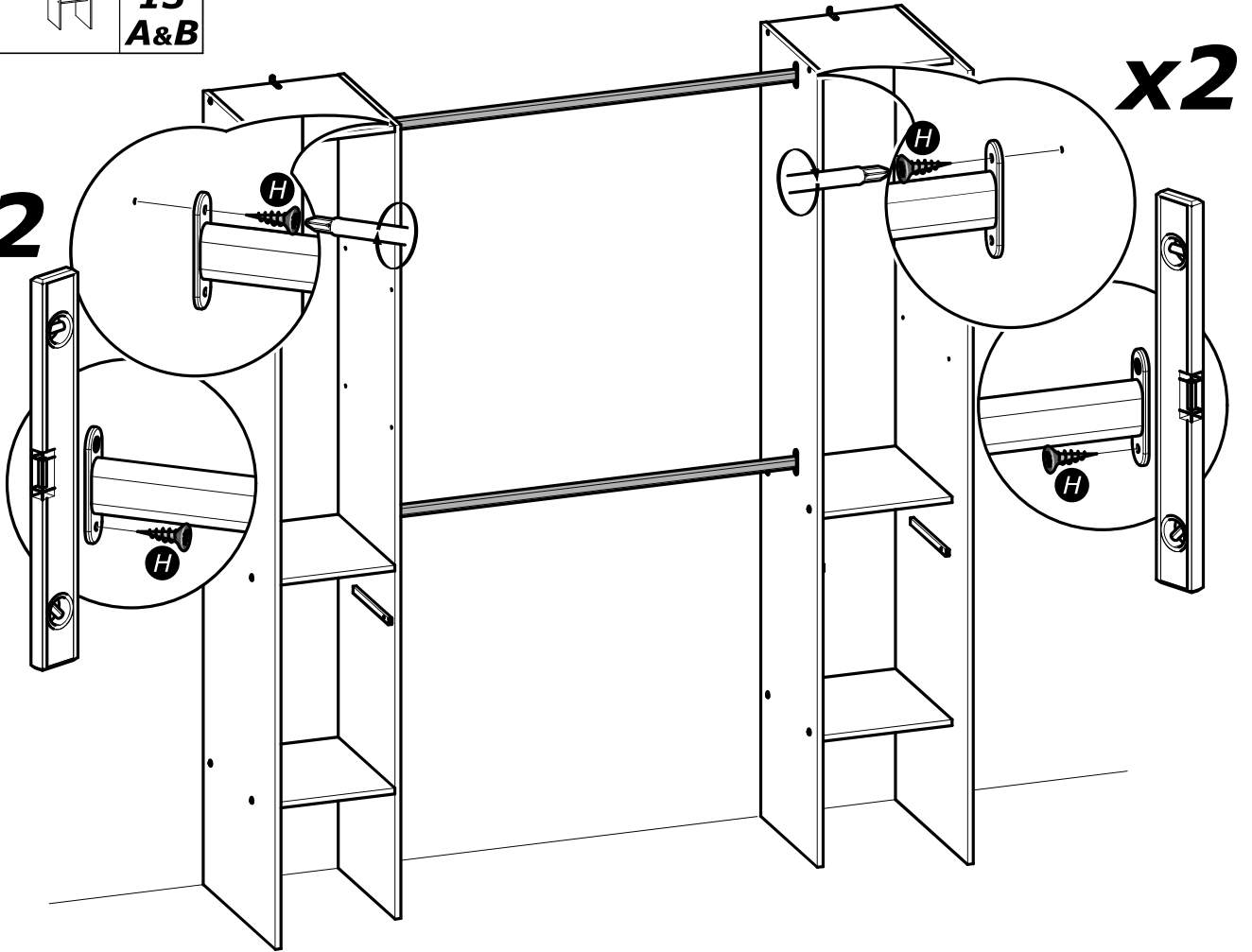

**D** x4

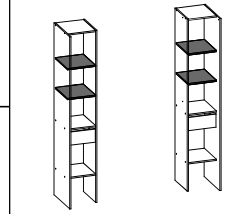

**14**  
**A&B**

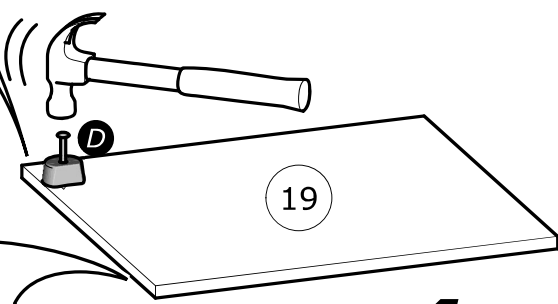

**x4**

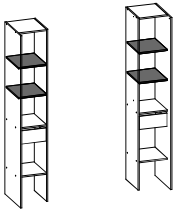

**E** x16

**15**  
**A&B**

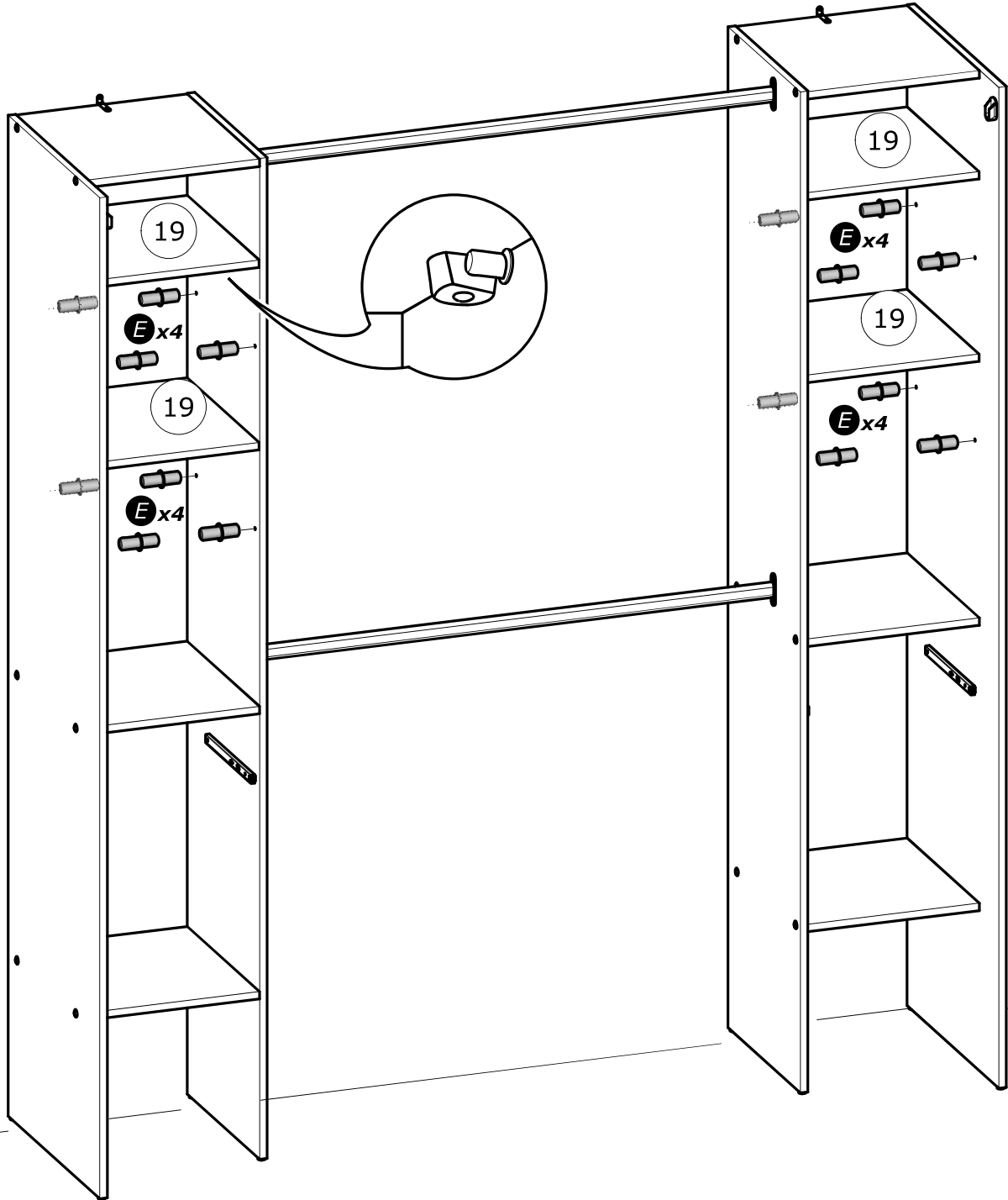



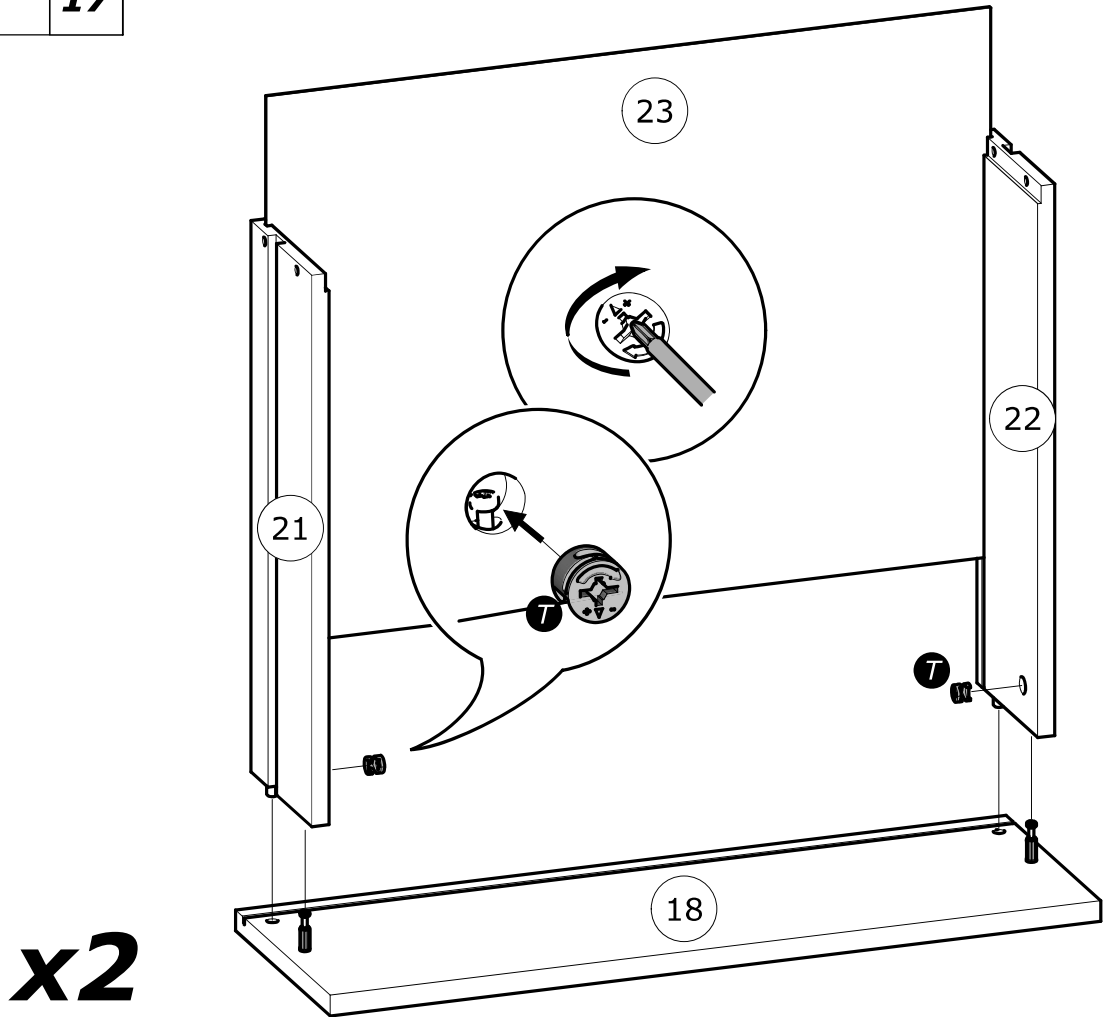
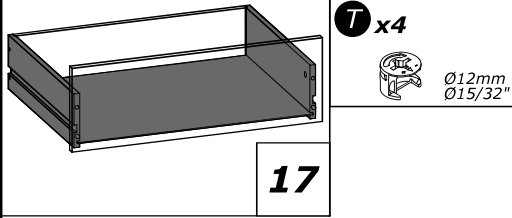
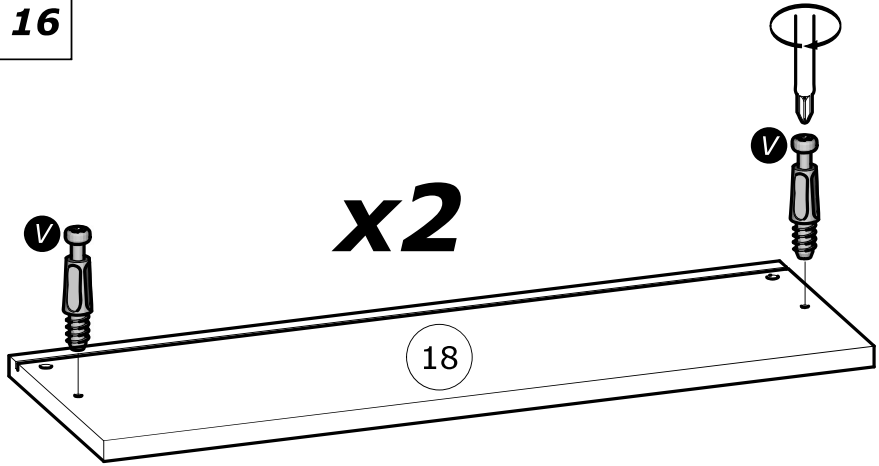
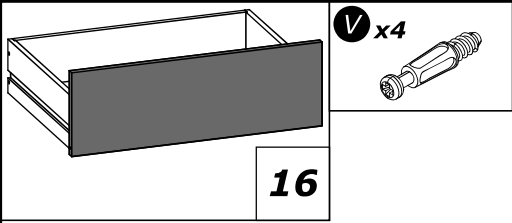

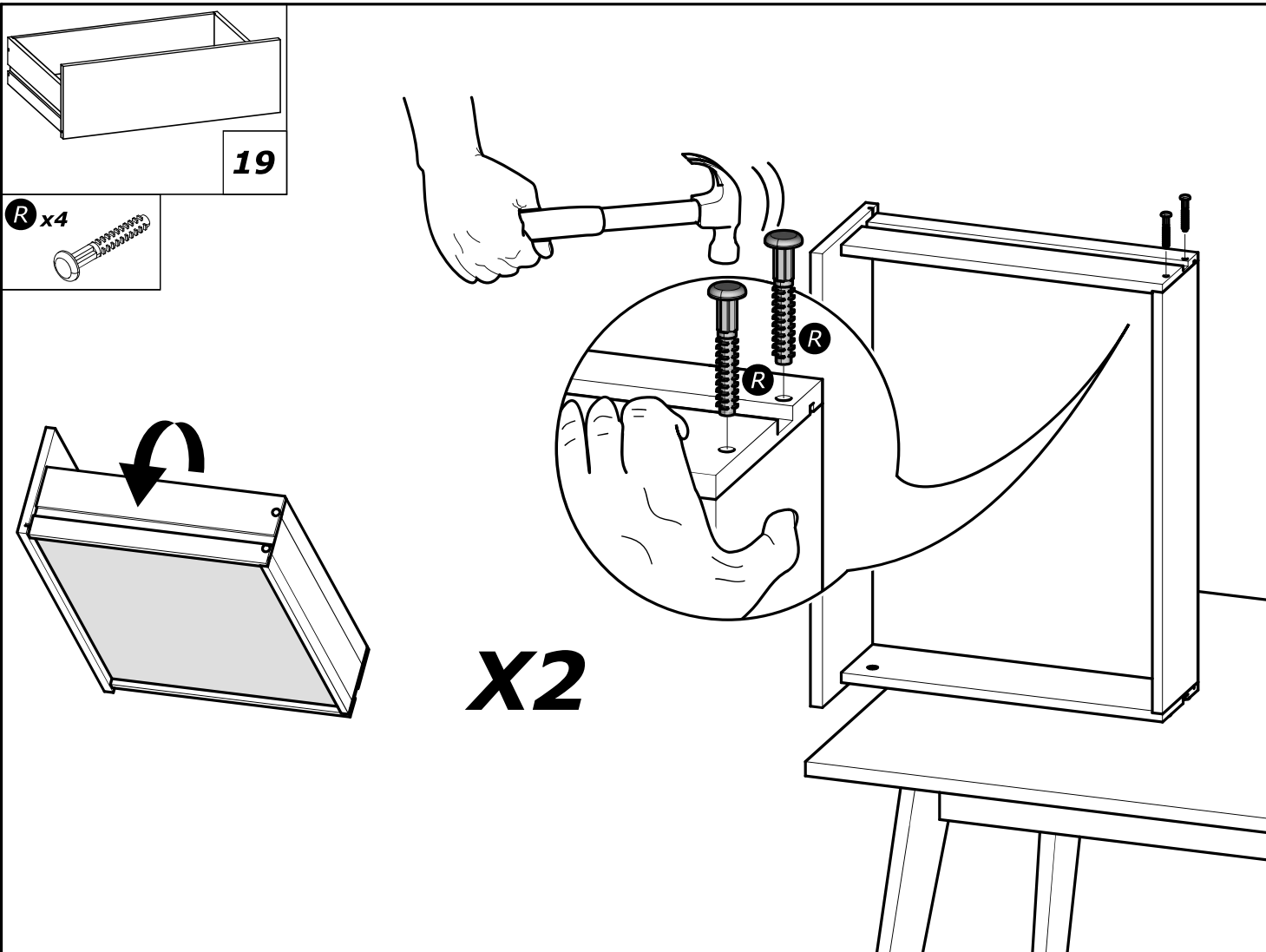
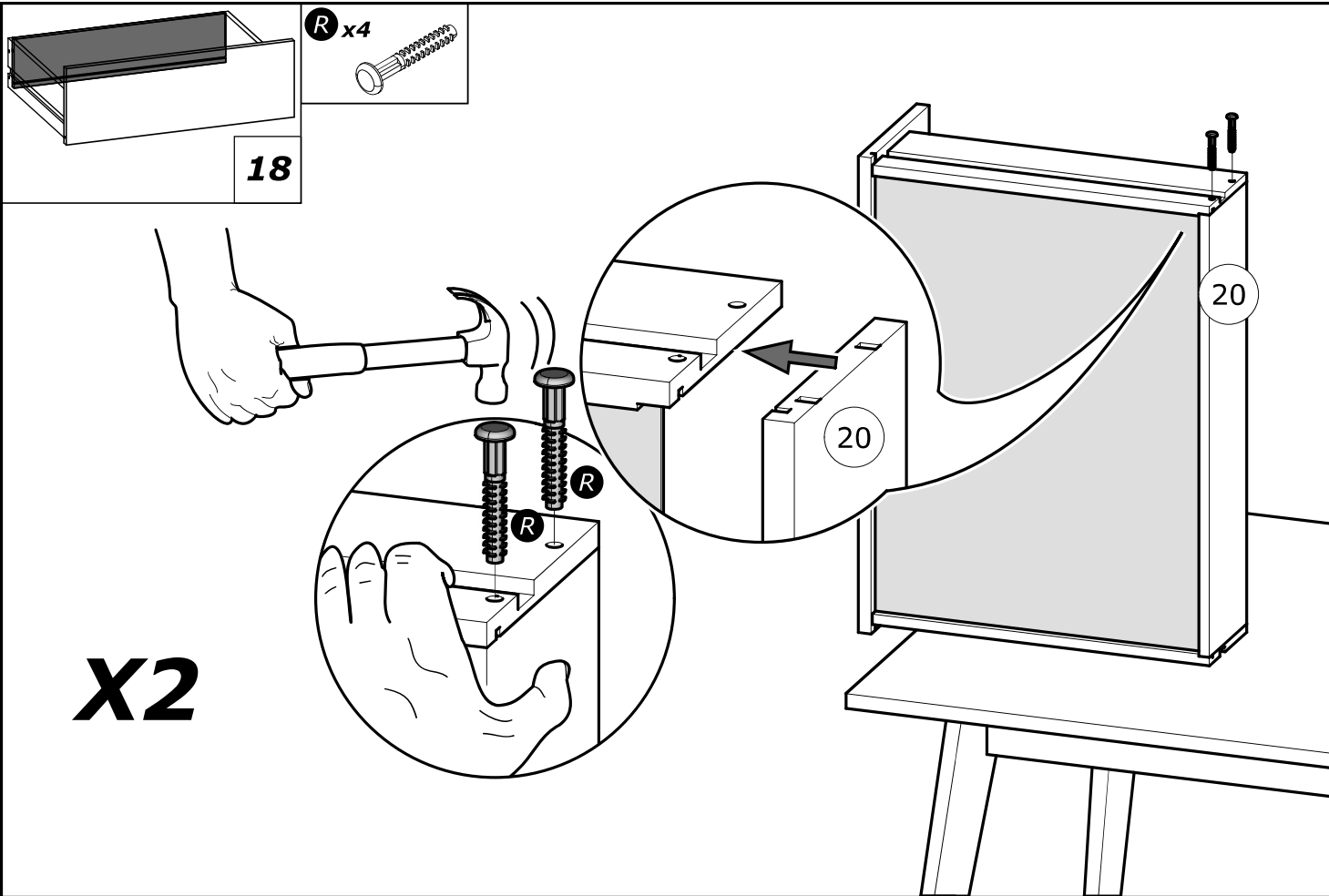

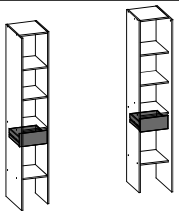

**I** x4  
4x9mm  
5/32" x 11/32"

**20**  
**A&B**



[www.Demeyere.fr](http://www.Demeyere.fr)

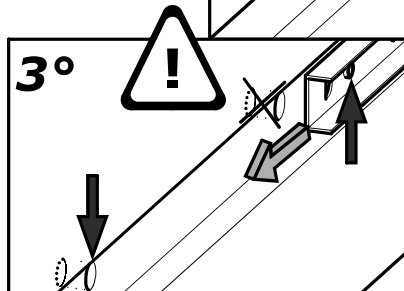
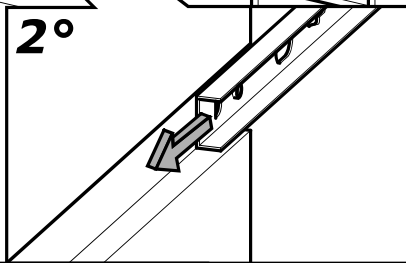
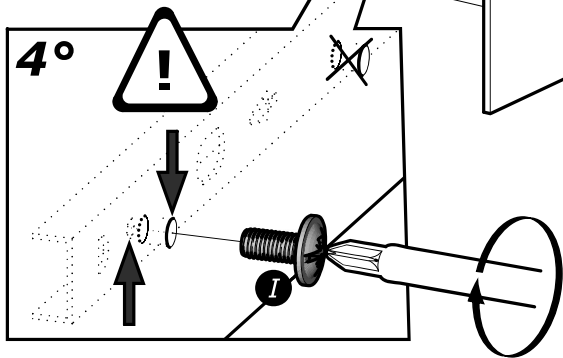
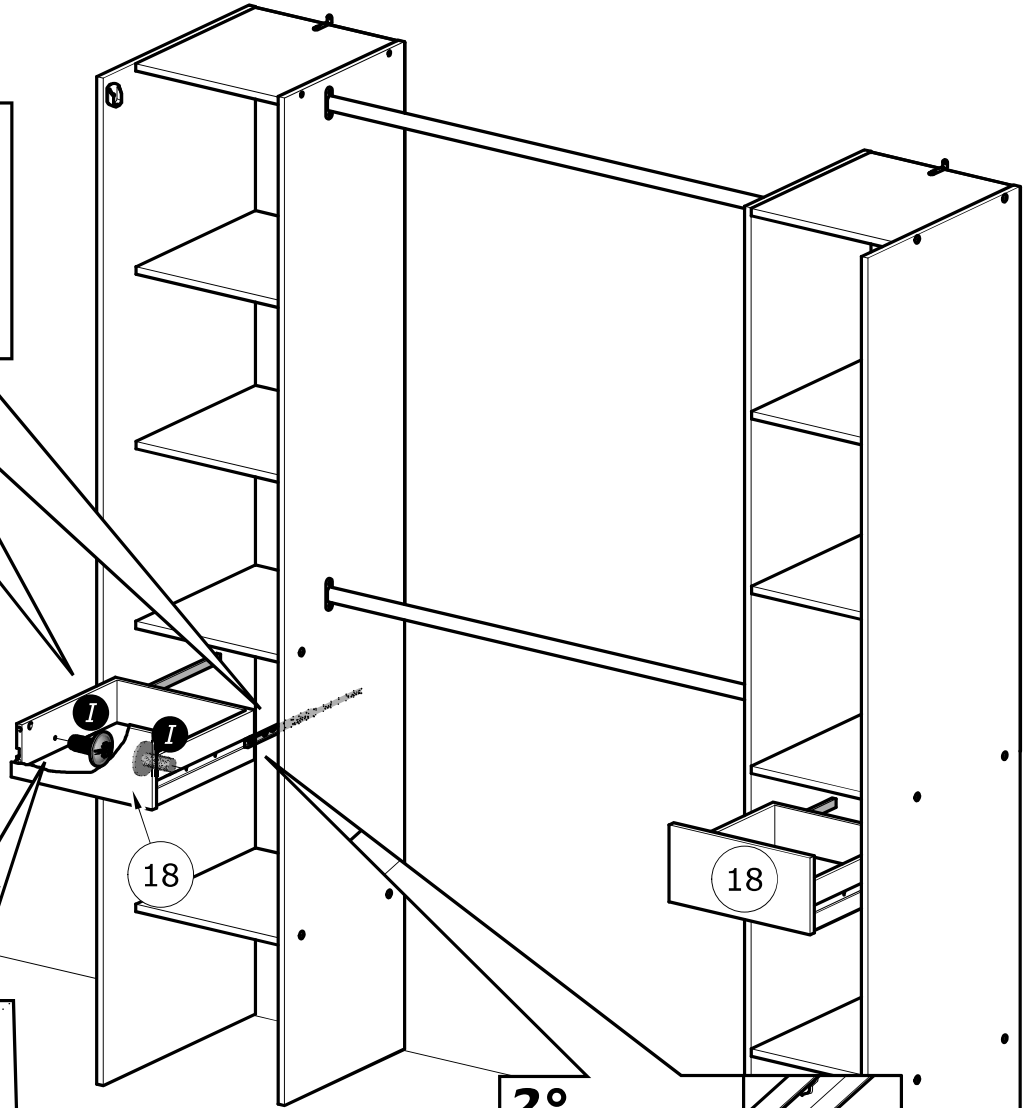
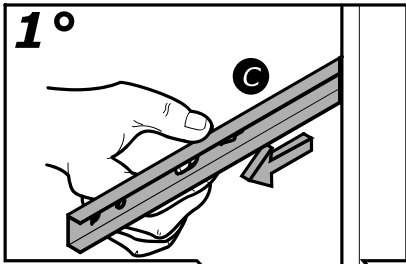

**x2**

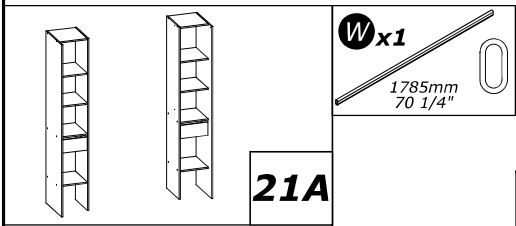
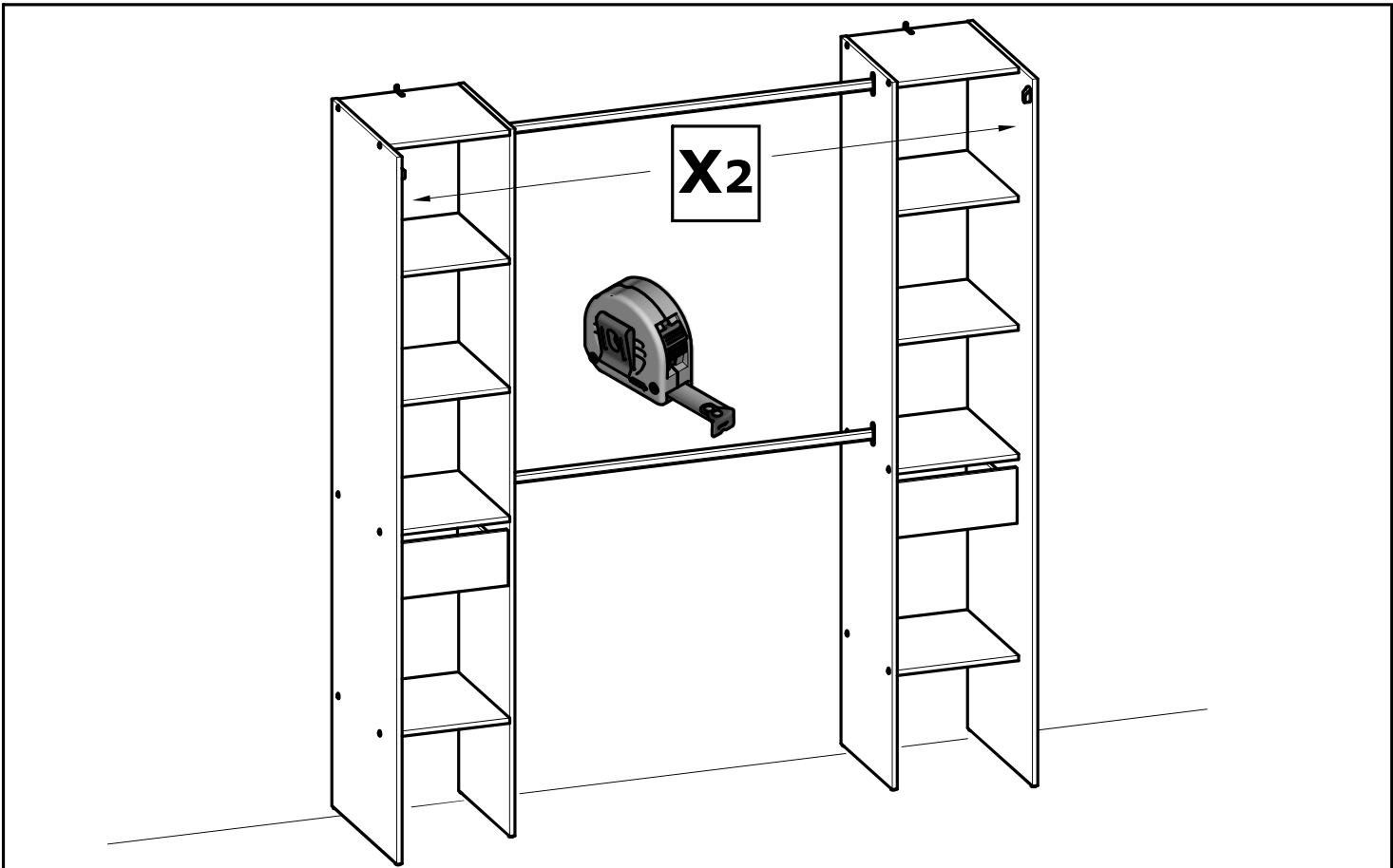

**X2** Max

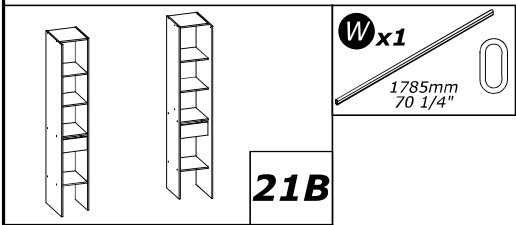
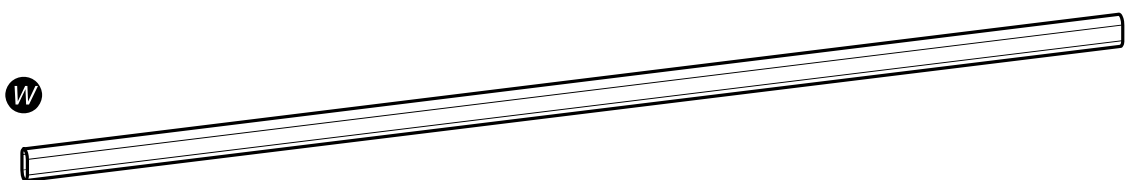
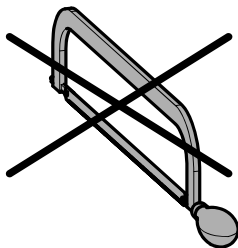

**X2** < Max

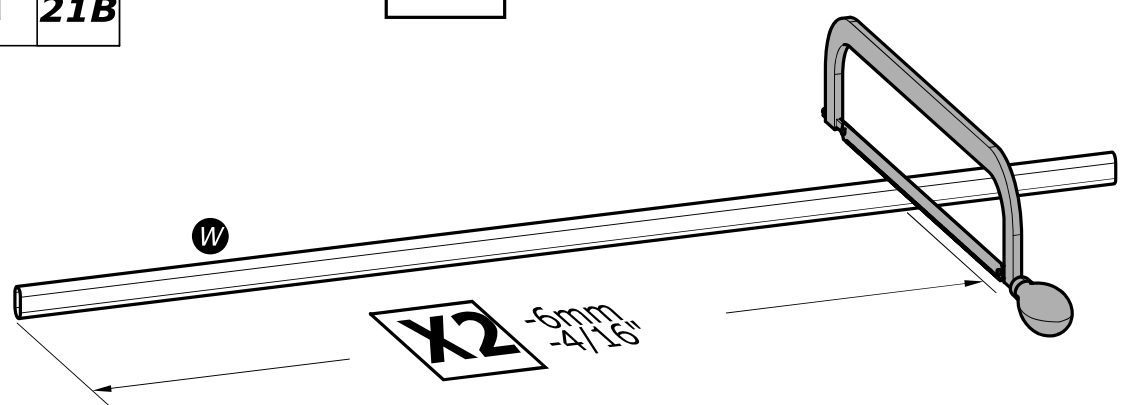

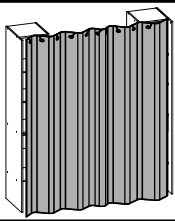

22  
A&B

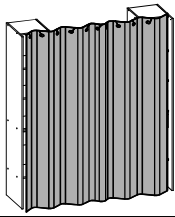
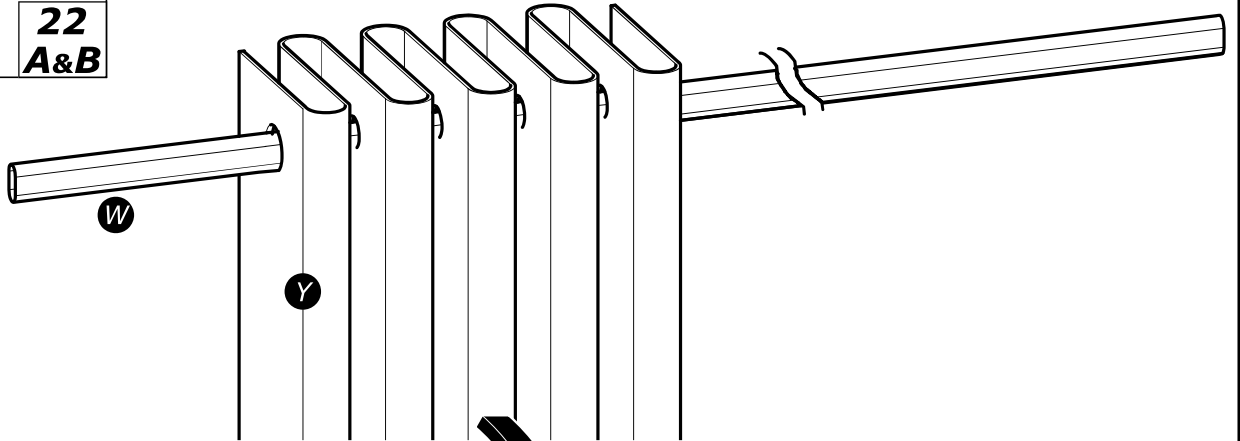
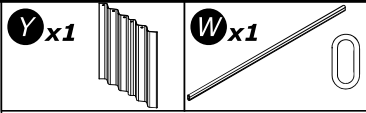

23  
A&B

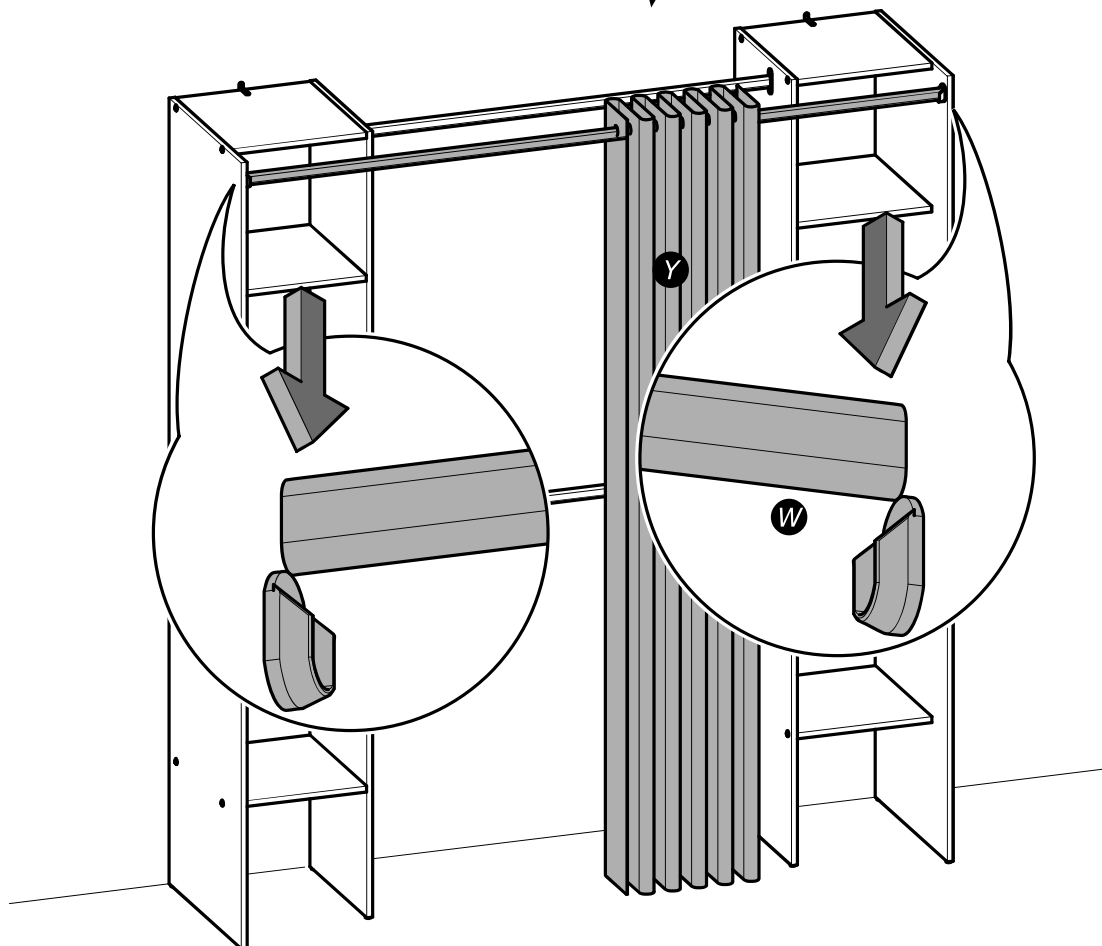
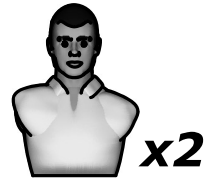

FR

Donnez ou recyclez  
vos meubles.



ou



ou



<https://quefairedemesdechets.fr>