

# BOM List for Products

<b>ADEO Ref</b>	846385
<b>EAN Code</b>	3276000448389

## Explosion Drawing

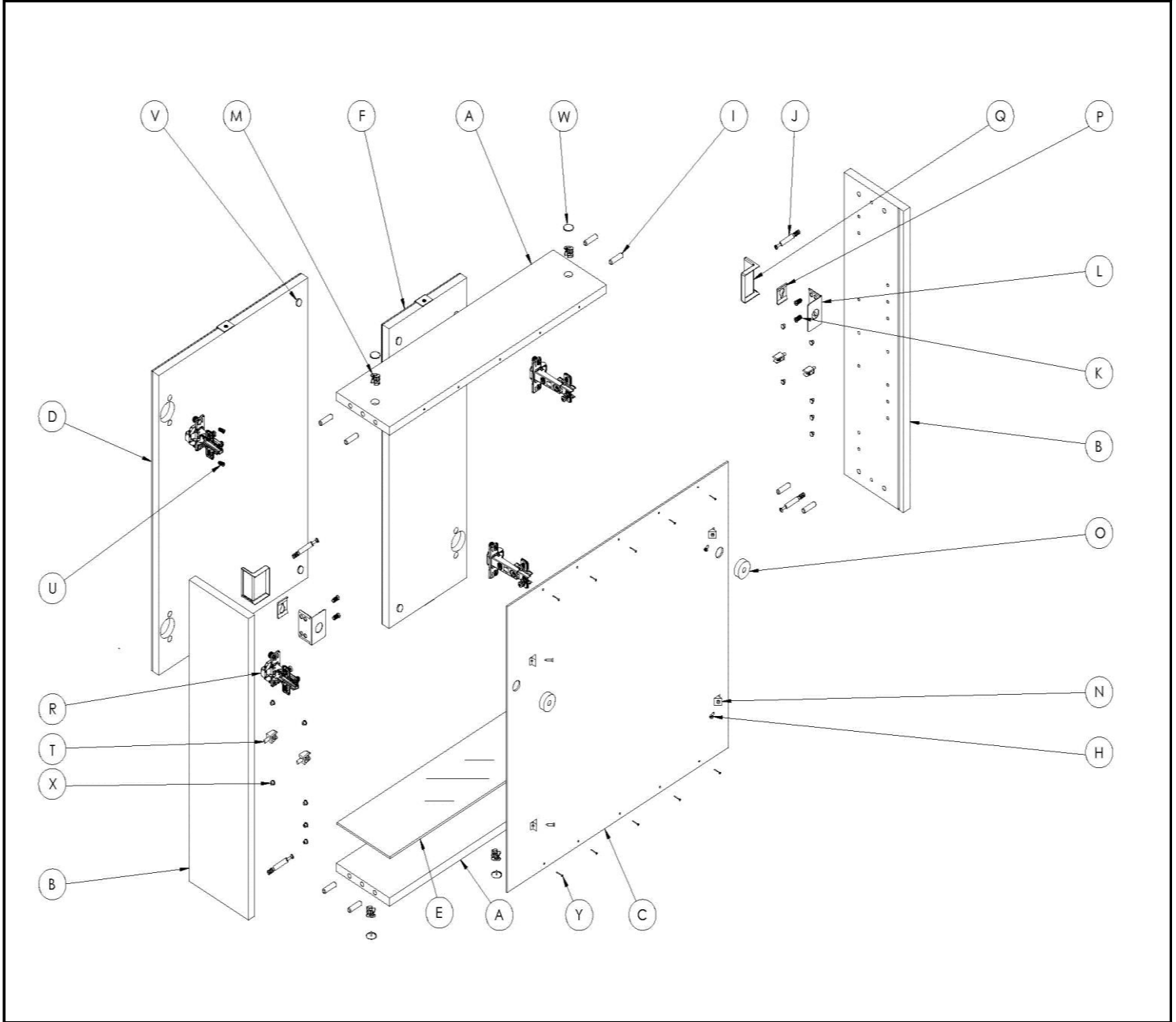

Parts No.	Quantity	Spec	Material & Surface process
A	2 pcs	550x135x15mm	Top and bottom panel, 15mm particle board 2 face white melamine, 2 long side PVC banding, back with holes for eccentric wheels.
B	2 pcs	580x151x15mm	Side panel, 15mm MDF 1 face white melamine, surface white wrapped, 2 short side PVC banding, back with holes for connecting rod, wood dowel, hinge and glass shelf support.
C	1 pc	550x560x3mm	Back panel, 3mm MDF 2 face white melamine, with holes for hanger and $\varnothing 3$ screw.

# BOM List for Products

ADEO Ref	846385		
EAN Code	3276000448389		
D	1 pc	580x378x18mm	Big Mirror door , 15mm particle board 2 face white melamine, 4 side PVC banding, 3mm mirror with explosion-proof film glued on, upper and down with 3mm thickness mirror's harder corner. Back with holes for hinge.
E	1 pc	541x131x6mm	Glass shelf, 6mm tempered glass
F	1 pc	580x197x18mm	Small Mirror door , 15mm particle board 2 face white melamine, 4 side PVC banding, 3mm mirror with explosion-proof film glued on, upper and down with 3mm thickness mirror's harder corner. Back with holes for hinge.
Y	10 pcs	∅3x16 screw	Stainless steel
H	4 pcs	∅3x15 screw	Iron nickel plating
K	4 pcs	∅6x13 screw	Galvanized iron
U	8 pcs	∅4x11 screw	Iron nickel plating
V	(2 in 1)*2	silicon pad	Silicon
T	4 pcs	glass shelf support	Zinc alloy
W	4 pcs	plastci cover for eccentric wheel	Plastic
X	12 pcs	stopper	Plastic
J	4 pcs	connecting rod	Galvanized iron
I	8 pcs	wood dowel	wood
O	2 pcs	Back spacer hanger	Plastic
M	4 pcs	eccentric wheel	Zinc alloy
P	2 pcs	adjustable metal plate	Galvanized iron
L	2 pcs	hanger	Galvanized iron
N	4 pcs	plastic support	plastic
Q	2 pcs	plastic cover	Plastic
R	4 pcs	Hinge	Cold rolled steel plated with nicke