

14

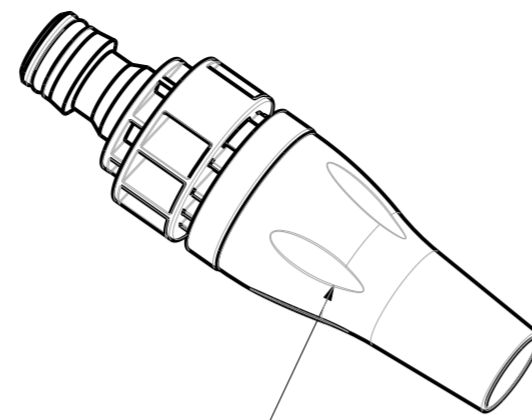

15



16

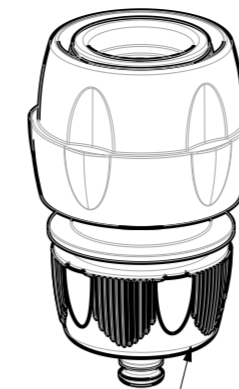

17

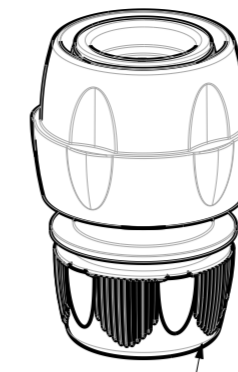

18

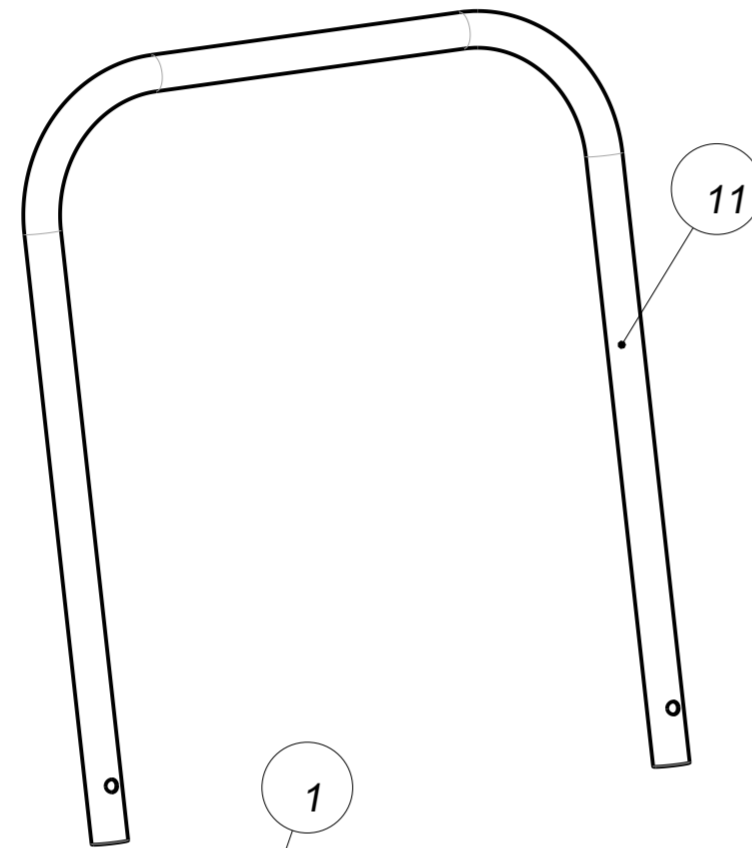

11

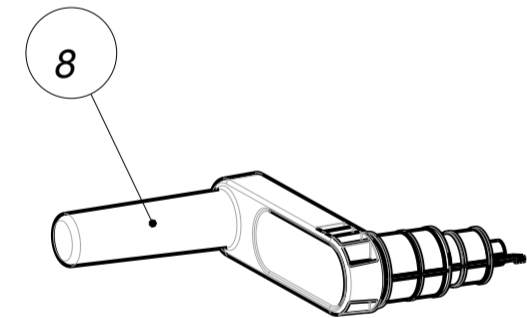

8

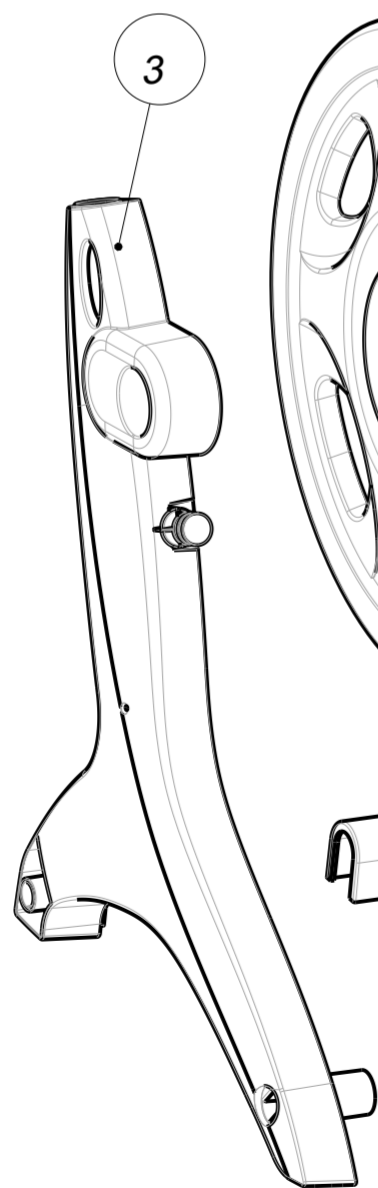

3

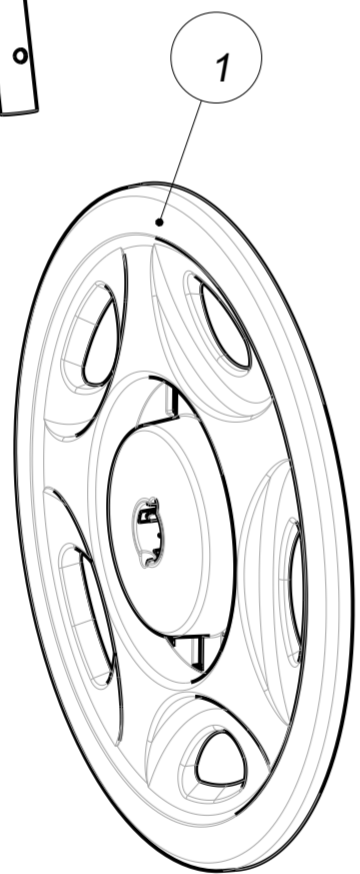

1

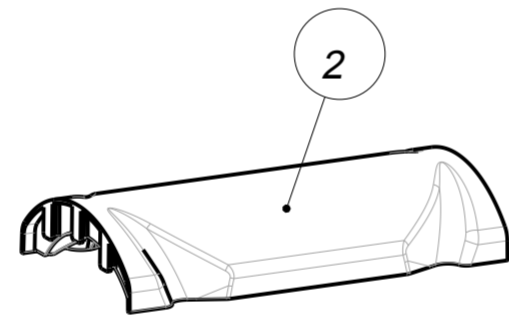

2

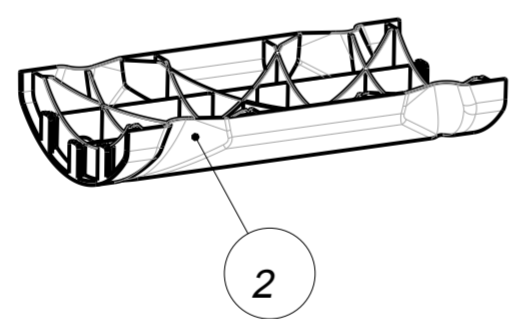

2

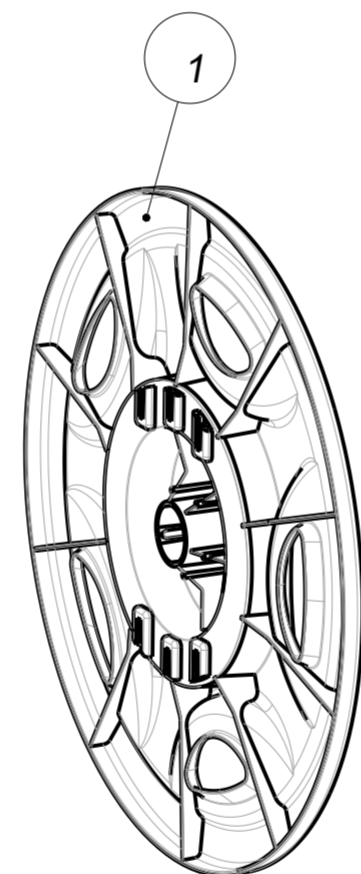

1

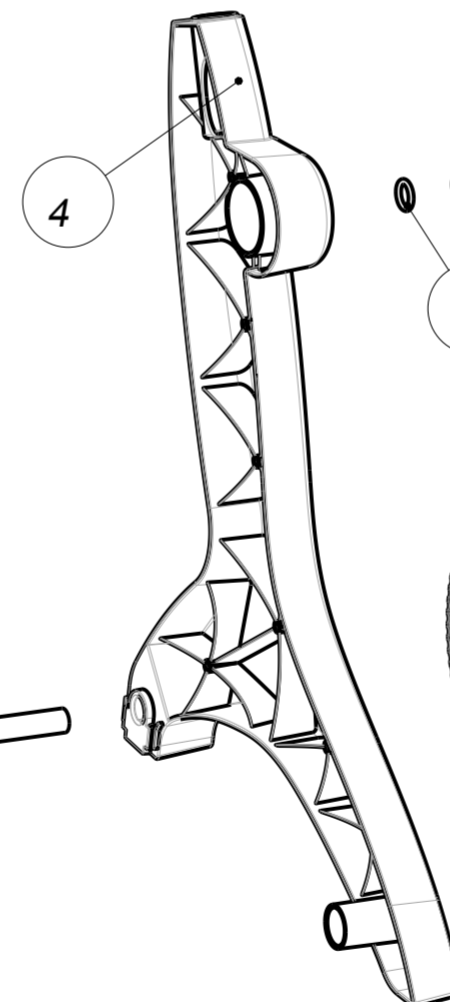

4

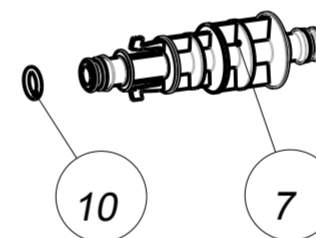

10



10



10

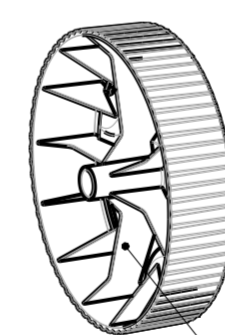

5



6

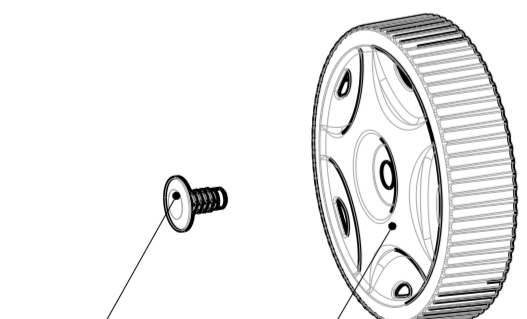

5

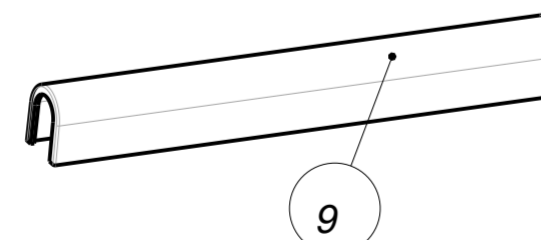

9

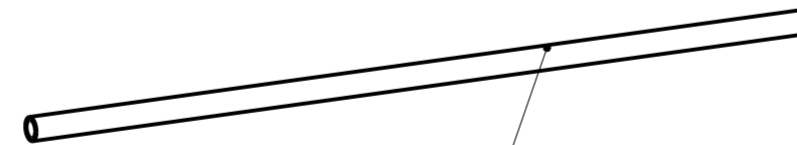

12

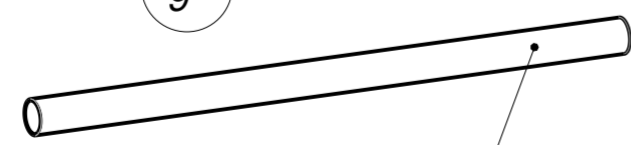

13

RIF	DESCRIPTION	NR
1	REEL SIDE	2
2	REEL CROSS	2
3	RIGHT SIDE	1
4	LEFT SIDE	1
5	WHEEL	2
6	WHEEL STOPPER	2
7	BRACKET	1
8	HANDLE	1
9	AXIS COVER	1
10	O-RING	2
11	UPPER HANDLE	1
12	WHEELS AXIS	1
13	FRONTAL TUBE	1
14	1/2" M20 HOSE	1
15	SPRAY NOZZLE	1
16	3/4" TAP ADAPTOR	1
17	1/2" AQUASTOP QUICK CONNECTOR	1
18	1/2" QUICK CONNECTOR	1

G.E.

CLASSE DI TOLLERANZA	SCOSTAMENTI LIMITE PER DIMENSIONI LINEARI	SMUSSI E RACCORDI	ANGOLARI	CODICE CLIENTE
DESIGN. DENOMIN.	0.5° >3 >6 >30 >120 >400	0.5 >3 >6	<=10 >10 >50	81965826
f fine	±0.05 ±0.05 ±0.1 ±0.15 ±0.2 ±0.3	±0.2 ±0.5 ±1	±1° ±0°30' ±0°20'	CODICE G.F.
SCALA	FORMATO	SFORMI NON QUOTATI	RAGGI NON QUOTATI	8000-5837
33:100	A2	max 1°	max R 0.2	CODICE EAN
COSTRUZIONE STAMPI STAMPAGGIO AD INIEZIONE TECNOPOLIMERI CORREGGIO (RE) ITALY				3276000412748
E' VIETATO L'USO E LA RIPRODUZIONE DEL PRESENTI DISEGNO SENZA AUTORIZZAZIONE SCRITTA				NUMERO DISEGNO
EQUIPPED TROLLEY 20m 12,5mm WITH LANCE AND CONNECTORS GEOLIA				-
DISEGNATO	APPROVATO	DATA	DIRECTORY	FOGLIO
Marcello	-	23-07-18	-	1 1
PESO (g) 0.000 VOLUME (cm3) 0.000 NOME FILE GF80005837				REVISIONE
				00