

S81110806TN S81110806STN

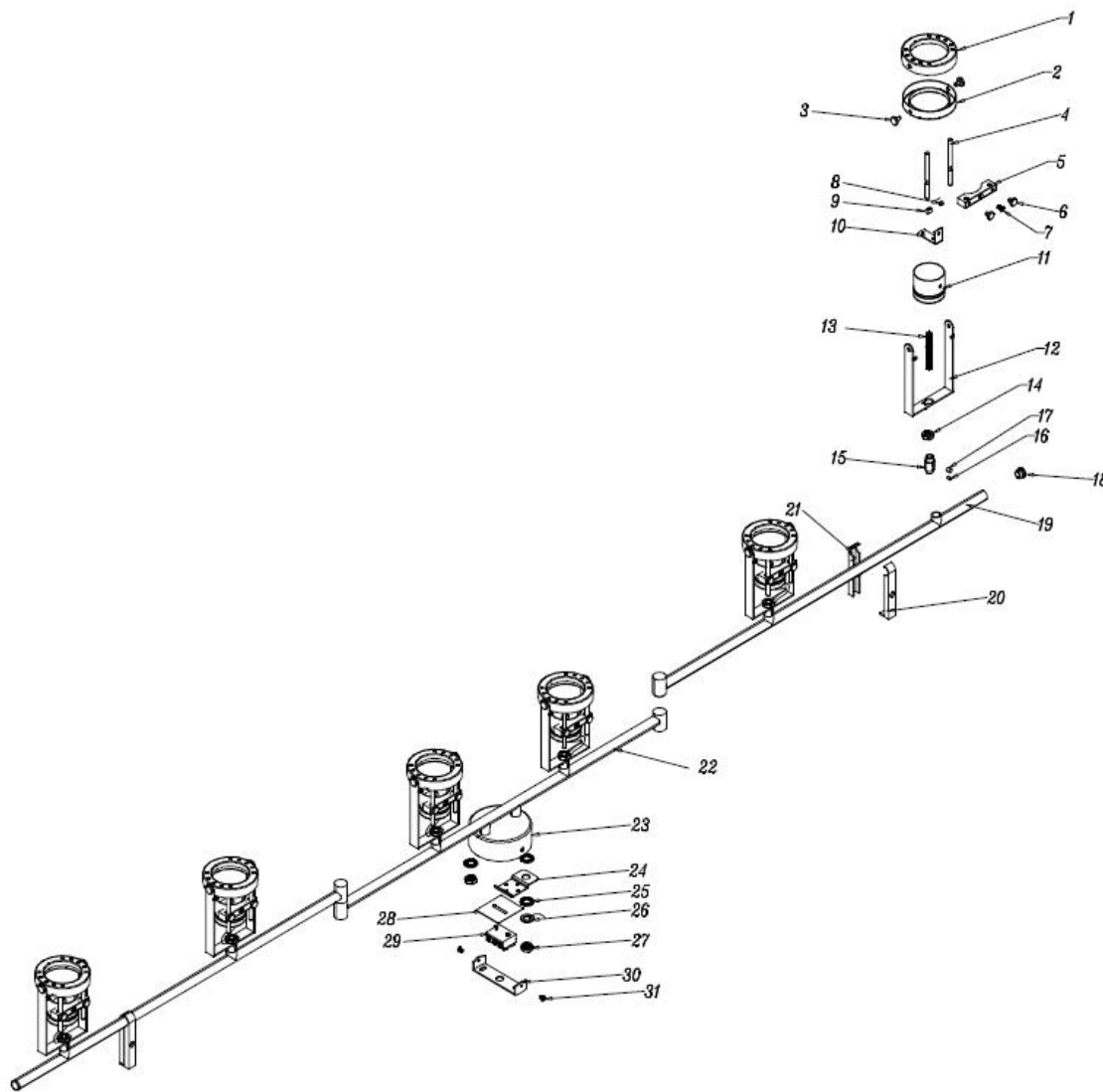

- 1 shade-A
- 2 shade-B
- 3 M4 screw
- 4 straight solid pole
- 5 metal
- 6 M4 screw
- 7 M4*12 headless screw
- 8 M4*5 plastic screw
- 9 hardware
- 10 bracket
- 11 shade
- 12 bracket-A
- 13 spring
- 14 M10 nut
- 15 hardware
- 16 headless screw
- 17 M5*6 plastic screw
- 18 end cap
- 19 Tube A
- 20 ceiling holder
- 21 ceiling holder
- 22 Tube B
- 23 Base
- 24 metal
- 25 selfstap screw
- 26 yellow/green earth wire
- 27 M10 screw nut
- 28 45*45 insulation paper
- 29 bracket
- 30 M4 screw