

Elenco parti						
RIF	GRP	QTA	CODICE DXF	CODICE F.	N.PARTE	DESCRIZIONE
1	GP	1		245GP19010	245GP19010	ASS. ROXY_ATRIUM
2	GC	2	241198071	241198071	CAC2413	SPESSORE MANIGLIA
3	GE	1		14513036	COM0288	SCHEDA N100-32 K--
4	GS	1		18013016	COM0518	GUAR. 06371 interasse fori 155X190
5	GC	1		120194010	COM0587	MANIGLIETTA SILICONICA
6	GE	1		145198010	COM2244	VENTILATORE DX FFR 180/30-1ASN HT
7	GE	1		145198030	COM3020	DISPLAY J100 3Tasti
8	GC	1	241194021	241194023	MNA0402	FRANGICALORE 4.9 KW
9	GS	1	241194041	241194043	MNA0405	FRANGICALORE SERBATOIO
10	GS	1	241194061	241194063	MNA0407	SUPPORTO DISPLAY
11	GS	1	241194091	241194093	MNA0410	CARTER ARIA FRONTALE
12	GC	1	240194501	240194503	MNA0505	PROFILO FRONTALE PORTA
13	GC	1	240194421	240194421	MNA1532	COPERCHIO SERBATOIO 169X208X3
14	GF	1	240194711	240194713	MNA1720	FIANCO SX ATRIUM 274x910x227
15	GF	1	240194721	240194723	MNA1721	CRUSCOTTO SUP. ATRIUM 180x272
16	GF	1	240194701	240194703	MNA1722	CRUSCOTTO INF. ATRIUM 272x192
17	GF	1	240194691	240194693	MNA1725	FIANCO DX ATRIUM 274x910x142
18	GC	1		240194684	MNA1790	ASS.TOP ATRIUM 645x277
19		1			MNA9801	ASS.STRUTTURA COMUNE 4.9-7KW
20		2		12013069	VIT0046	VITE AUTOF. ZNB SENZA PUNTA 4.2X9.5
21		19		120194020	VIT0301	VITE AUTOFIL T1/2T+4.2X9.5 ZIGR. ZNB
22		6		120194030	VIT0302	VITE AUTOFIL T1/2T+4.2X9.5 ZIGR. ZNN

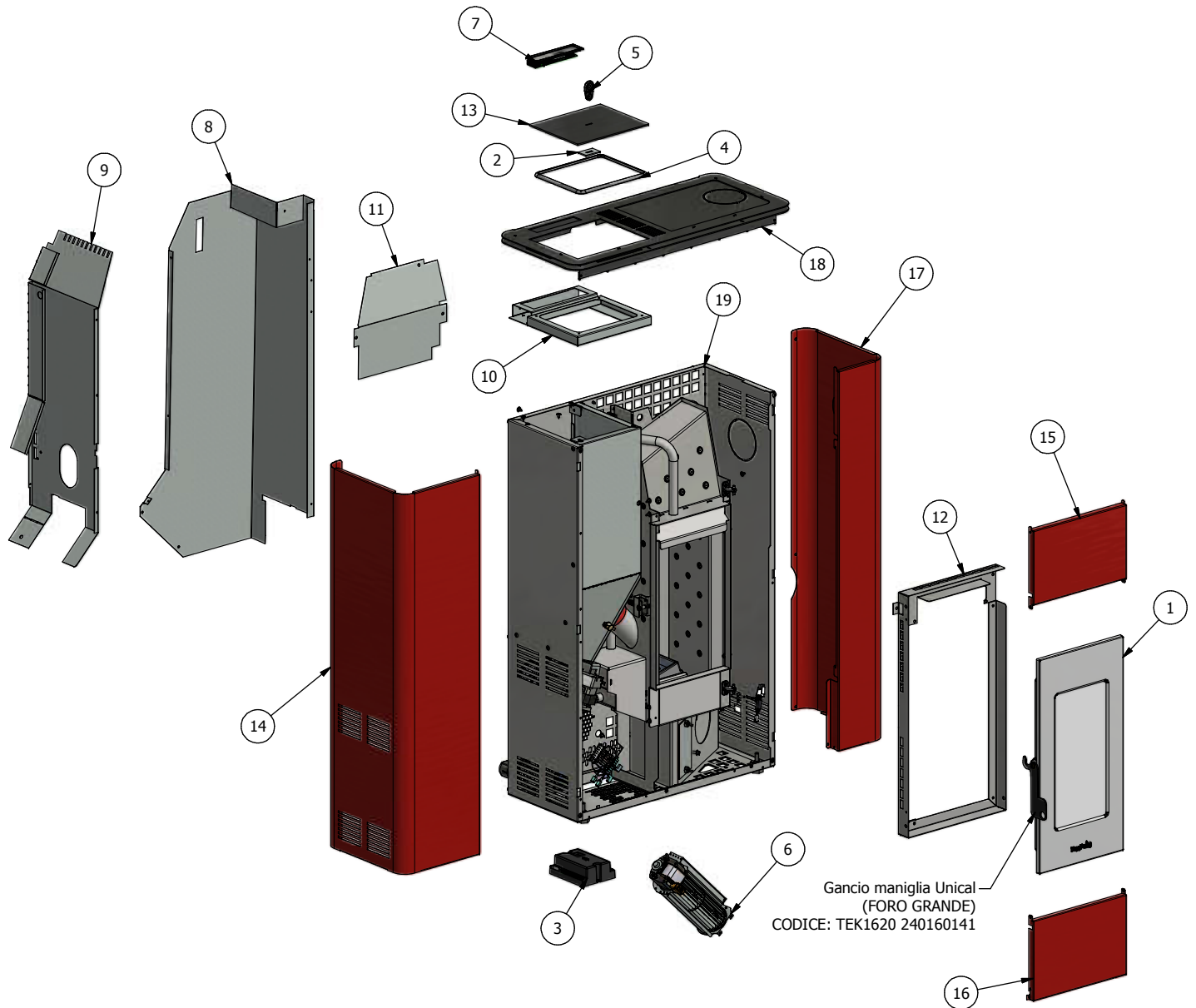

	Descrizione		1   Prima emissione		24/09/2019   tecnico3   Roberto			
	ASSIEME STUFA ATRIUM 4,9 KW FREEPOINT		Nr	Changes	Date	Signature	Seen by	
	Sviluppo		Designer: <b>Simone</b> Controllo: <b>Simone</b> General Tolerances: Dimensions <=500mm=+/- 0.3   Non measured angles at 90° =+/-1° Dimensions >500<1000mm=+/- 0.6   Measured angles =+/-1° Dimensions >=1000mm=+/- 1					
Area	N. Pieghe	Kg	Prov.	Tipo Verice	Destinazione	Scala	Date	Numero Parte
10443384,805 mm <sup>2</sup>		56,272 kg			Magazzino	1 : 10	22/03/2019	MNA9917
Codice DXF			Codice Finito					

According to the law, this drawing is the property of CADEL. Any reproduction or disclosure to third parties without the prior written authorization is strictly prohibited.