

Adeo model: TH30DP4

NOTE ORIENTATION

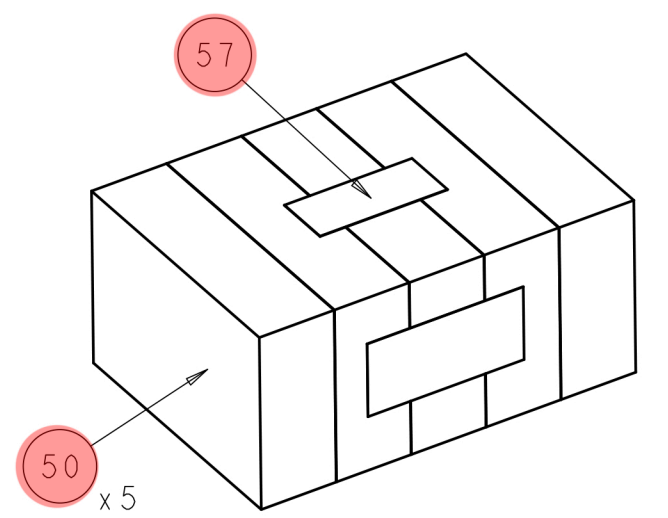
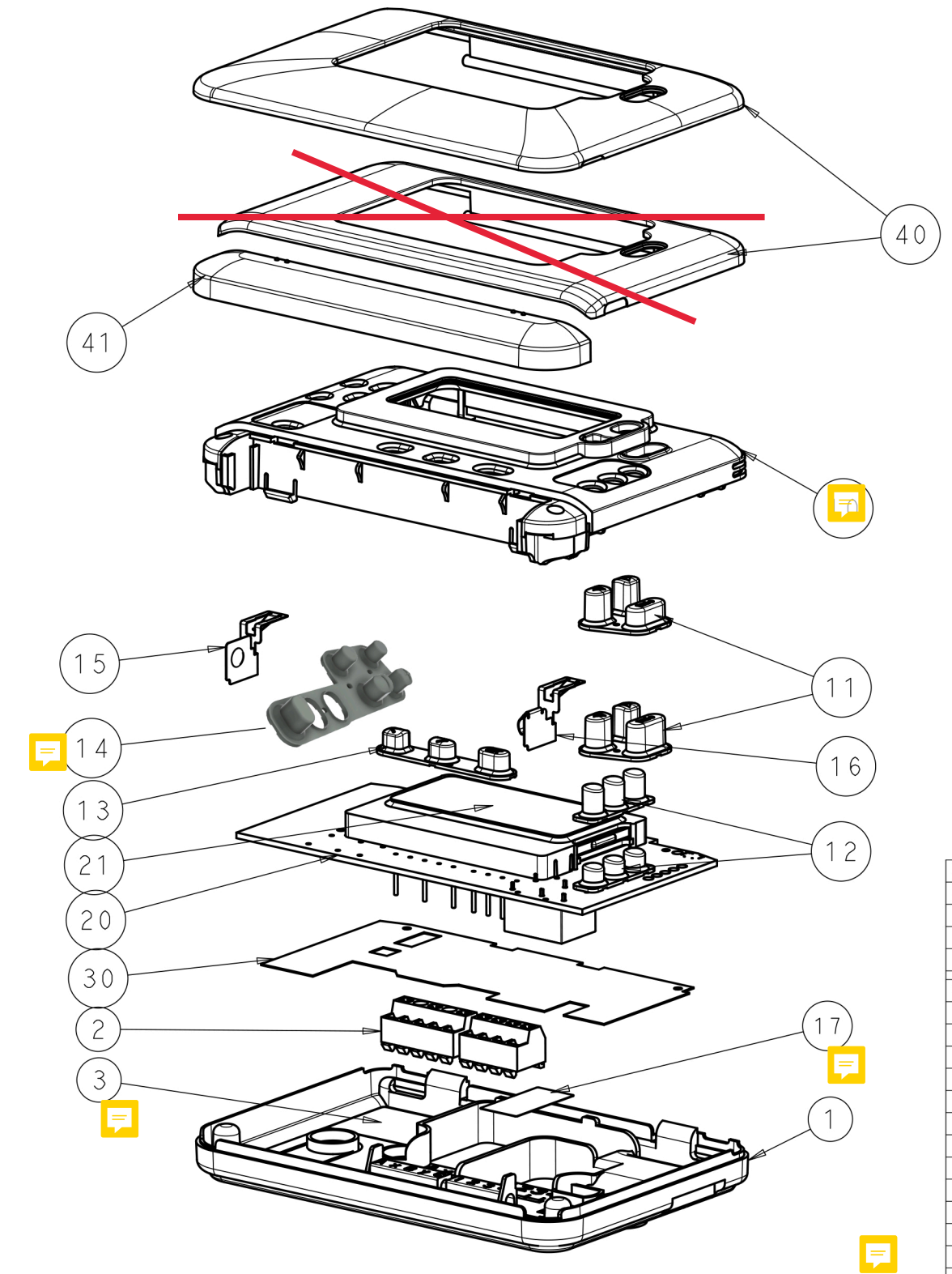
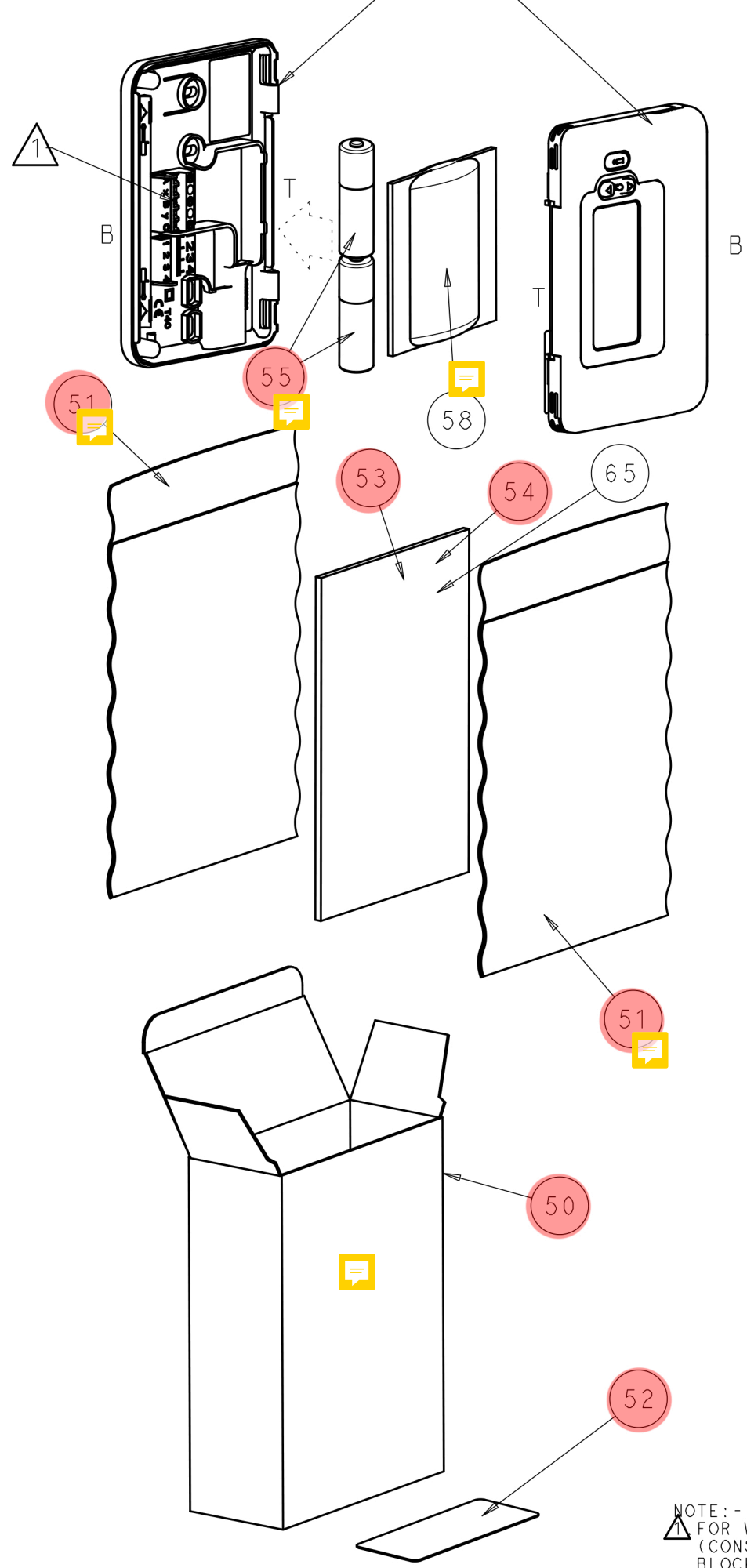

24TH SEPTEMBER 2020
 MARKUP BOMS APPROVED
 BY KEITH AITKEN
 R&D SITE LEADER
Keith J. Aitken

FIND	PART No.	DESCRIPTION	QTY
WALLPLATE ASSEMBLY			
1	42010890-001	WALLPLATE	1
2	42010926-001	TERMINAL BLOCK (MAINS)	1
3	42010953-001	LABEL WIRING	1
COVER ASSEMBLY			
10	42010929-001	COVER PRINTED	1
11	42010911-001	BUTTON (RHS)	1
12	42010913-001	BUTTON (MODE)	1
13	42010910-001	BUTTON (BOTTOM)	1
14	42010912-001	BUTTON (LHS)	1
15	32320727-001	CONTACT (BATTERY - POSITIVE)	1
16	32320726-001	CONTACT (BATTERY - NEGATIVE)	1
17	42010962-001	LABEL DATE CODE	1
20	42010884-001	PCB	1
21	42010899-001	LCD MODULE (NO BACKLIGHT)	1
25	42010958-001	SOFTWARE HEX CODE	REF
30	42010935-001	INSULATOR	1
40	42010892-001	FLAP (FULL)	1
41	42010894-001	BATTERY COVER	1
PACKAGING			
50	42010930-001	CARTON	1
51	42010931-001	FOAM BAG	2
52	42010954-001	LABEL CARTON	1
53	30023963-001	LITERATURE PACK	1
54	42005514-001	AA BATTERY	2
56			
57	42004921-507	LABEL, 3 OFF	0.2
58	42000684-079	BAG ASSEMBLY	1

NOTE :-
 FOR WHITBREAD-1.5KW VERSION APPLY ANTI FRETTING COMPOUND
 (CONSUMABLE PART NUMBER 2546) TO THE RECEPTIBLES OF TERMINAL
 BLOCK (FIND 2) AVOIDING THE SCREW HEADS.