

# PRELIMINARY

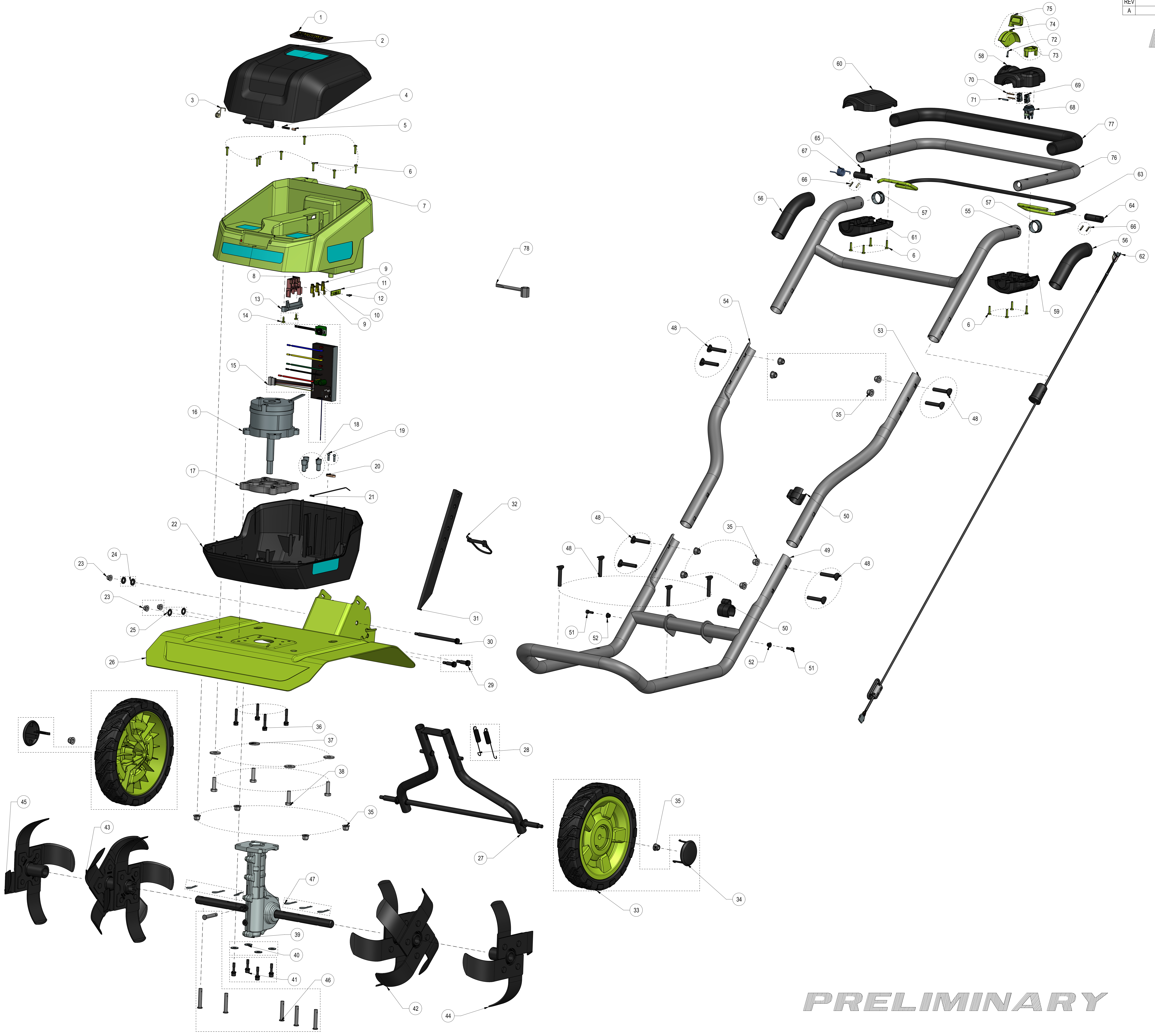

ITEM	TTI PRC	QTY	PART NAME	PLM ID	REMARK
78	612330001	1	WRENCH	CL00001023	
77	566487002	1	RUBBER, FOAM TUBE \ ID24.00MM x THK3.50MM \ 095	CL00112096	
76	683749001	1	UPPER TUBE, OD25.00 X ID22.60 MM \ DARK SILVER 9	CL00111282	
75	543812001	1	PLASTIC,SPEED CONTROL PADDLE \ 095678	CL00075173	
74	543917001	1	PLASTIC,SPEED CONTROL PADDLE BOTTOM \ 095678	CL00075174	
73	543813001	1	PLASTIC,START BUTTON \ 095678	CL00073530	
72	660203002	1	ST SCREW M3x1.058 PH PHILIPS #2 B	CC00000374	
71	673924001	1	DIAL LEVER INSERT	CL00037736	
70	674443001	2	PIN, DIA2.50MM \ 095750	CL00104988	
69	760595004	2	MICRO SWITCH VDE 5/2.5A 125/250VAC.3A 30VDC	CL00079397	
68	760653001	1	PUSH BUTTON SWITCH, SC7097-4W2V, UL	CL00057236	
67	683081001	1	TORSION SPRING, DIA2.00MM \ 095750	CL00105246	
66	674290002	4	SPRING PIN, CARBON STEEL \ DIA3.0x14.0MM \ 09575	CL00103861	
65	545546001	1	PLASTIC,RIGHT ACTUATOR \ POM \ 095750	CL00091960	
64	545545001	1	PLASTIC,LEFT ACTUATOR \ POM \ 095750	CL00091950	
63	683750001	1	METAL, BAIL BAR \ 095669	CL00114800	
62	292417002	1	MAIN WIRE ASSY \ 095669	CL00112970	
61	545508001	1	PLASTIC,ACTUATOR INNER HOUSING \ ABS \ BLACK	CL00091710	
60	545507001	1	PLASTIC,ACTUATOR OUTER HOUSING \ ABS \ BLACK	CL00091723	
59	545506001	1	PLASTIC, SPEED CONTROL INNER HOUSING \ ABS \ B	CL00091725	
58	545505001	1	PLASTIC, SPEED CONTROL OUTER HOUSING \ ABS \	CL00091724	
57	543885001	2	PLASTIC,BUSHING \ 095282	CL00074865	
56	567009001	2	RUBBER, INSULATION FOAM \ ID28.50MM x THK2.50M	CL00112842	
55	683748001	1	MIDDLE TUBE, OD30.00 X ID27.60 MM \ DARK SILVER	CL00111158	
54	683822002	1	RIGHT FOLDING TUBE, OD30.00 X ID27.00 MM \ DARK	CL00129239	
53	683821002	1	LEFT FOLDING TUBE, OD30.00 X ID27.00 MM \ DARK S	CL00127600	
52	678774007	2	NUT FLANGE M5X0.8,NYLON LOCK	67877400700099	
51	660901001	2	SCREW,SHCS, M5 X 0.8 X 14 - STEEL, BLACK PHOSPH	66090100100099	
50	544302001	2	PLASTIC, CORD RETAINER (Ø30) \ PA6 GF30 \ 090405	CL00078967	
49	683048003	1	LOWER TUBE, OD30.00 X ID27.00 MM \ DARK SILVER 9	CL00129410	
48	663206001	-	M SCREW,STEEL TH M8.0X1.25 B \ L=47MM	CL00104869	
47	683064001	6	CLEVIS CLIP, DIA 1.80MM \ 095750	CL00092487	
46	674407001	6	PIN FOR TINES, DIA 7.90 MM \ 095750	CL00104990	
45	682632002	1	10" 4TEETH TINE WELDED ASSEMBLY \ OUTER RIGHT \	CL00113256	
44	682631002	1	10" 4TEETH TINE WELDED ASSEMBLY \ OUTER LEFT \	CL00113239	
43	682630002	1	10" 4TEETH TINE WELDED ASSEMBLY \ INNER RIGHT \	CL00113238	
42	682629002	1	10" 4TEETH TINE WELDED ASSEMBLY \ INNER LEFT \	CL00113235	
41	660058008	4	M SCREW,STEEL TH M6X1-6h CH W/SPRING WASHER	66005800800099	
40	680335079	4	WASHER UNDER NUT,65 MN OD18XID6.6X1.5MM \ 01805	68033507900099	
39	220782002	1	GEAR BOX ASSY \ 09575001DG9	CL00090777	
38	661689002	4	M SCREW M8X1.25X28 HEX HEAD	MM00071817	
37	671395001	4	FLAT WASHER 8.6X25.2x2.5	CC00000516	
36	663095001	4	M SCREW,STEEL	CL00065428	
35	678774002	18	NYLON NUT,SELF LOCK NUT M8x1.25	67877400200099	
34	542861001	2	PLASTIC, WHEEL HUB CAP \ 090565	CL00067597	
33	317159006	2	PLASTIC,10" WHEEL WITHOUT BEARING AND USING	CL00105031	
32	674460001	1	PIN,WHEEL PIN \ 095751	CL00104479	
31	656485002	1	STAMPING, DRAG STAKE \ 8MM THICKNESS \ VE \ 095	CL00129528	
30	663189001	1	M SCREW,STEEL TH M6.0X1-6h CH HEXAGON RECES	CL00103926	
29	663190001	2	M SCREW M6X1.0-6h L=29MM	CL00103982	
28	683155001	2	TENSION SPRING, DIA1.30MM \ 095750	CL00098739	
27	683152001	1	WHEEL AXLE ADJUST BRACKET \ 095750	CL00097213	
26	666437002	1	STAMPING, TINE SHIELD WELDED ASSEMBLY \ VE \ 095	CL00127294	
25	678587002	2	FLAT WASHER OD16xID8.5 Thickness: 1.5 FOR WHEE	67858700200099	
24	638128019	2	FLAT WASHER,Ø8.1xOD16x2 \ 090930119	63812801900099	
23	678774009	3	NYLON LOCK FLANGE NUT M6X1.0	67877400900099	
22	545500001	1	PLASTIC, BATTERY BASE \ ABS \ BLACK \ 095750	CL00091761	
21	790055001	1	NYLON CABLE TIE	CL00007428	
20	513211001	1	PLASTIC, CORD CLIP \ NATURAL	CL00007499	
19	660024061	2	ST SCREW,STEEL CH M4.0X1.8 PH TORX T20 B \ L=14	CL00009245	
18	870290001	3	CLOSE-END CONNECTOR \ 090825001DG9	CL00044071	
17	644608001	1	SUPPORT BLOCK \ 095750	CL00083109	
16	742912001	1	MOTOR,36V-DC #1000 \ HUAJIE 6000RPM 5A 1100W O	CL00091071	
15	281335103	1	RYOBI 36V FRONT TINE CULTIVATOR RY36CVXA-0	CL00122189	
14	660608001	2	TAPTITE SCREW,STEEL CH M4X1.588 PH TORX T20 P	66060800100099	
13	545577001	1	PLASTIC, PRESSING PLATE FOR TERMINAL HODLER \	CL00092542	
12	660203001	1	ST M3*8	66020300100099	
11	525651001	1	BATTERY COVER CONNECTOR	52565100100099	
10	638991001	1	STAMPING \ BATTERY CONTACT PLATE TERMINAL \ B	63899100100099	
9	638991004	2	STAMPING \ BATTERY CONTACT PLATE TERMINAL	CL00001866	
8	525692001	1	PLASTIC, CONTACT HOLDER FOR BATTERY \ PA6+30	52569200100099	
7	545499001	1	PLASTIC, BATTERY BUCKET \ ABS \ HYPER GREEN 54	CL00091760	
6	660466001	17	SCREW, TRILOBULAR	66046600100099	
5	621628001	1	METAL, BATTERY DOOR AXLE Ø5.0X1.0MM	801900079	
4	679073001	1	METAL, BATTERY DOOR PRESS SPRING	801800079	
3	679074006	1	METAL, BATTERY DOOR TORSION SPRING \ ZN PLAT	CL00091545	
2	545365002	1	PLASTIC, BATTERY COVER \ ABS TRANSLUCENT \ BL	CL00113465	
1	567006001	1	RUBBER, RYOBI MAXPOWER BRUSHLESS \ SNOW TH	CL00112125	

# PRELIMINARY

PART & PROCESS BASED CONFORM WITH TR REQUIREMENTS OF HAZARDOUS SUBSTANCE FREE			UNLESS OTHERWISE SPECIFIED DIMENSIONS ARE IN MILLIMETERS ALL RIGHTS OF DESIGN OR INVENTION ARE RESERVED.
TECHTRONIC INDUSTRIES COMPANY LIMITED			
<b>Techtronic Industries Co. Ltd.</b> <b>EMEA, RY36CVXA-0 \ RYOBI 36V FR</b>		<b>CONFIDENTIAL</b> THIS DRAWING IS DESIGN AND DETAIL IS THE PROPERTY OF TECHTRONIC INDUSTRIES COMPANY LIMITED	METRIC UNLESS OTHERWISE SPECIFIED DIMENSIONS ARE IN MILLIMETERS 3RD ANGLE PROJECTION
<b>108669001C</b> PART NUMBERS	COLOR SCALE 1:3 SHEET 1 of 2 DRAWN BY KUNH HUANG REV A	MODEL NO. CL00129480	PROJECT NO. CL00129480